



**OWNER'S MANUAL**  
**PRODUCT CODE: 6052**  
**4 DRAWER**  
**WORKSHOP TROLLEY**



Dimensions	Warranty	Wheel Size	Load Capacity	Weight
850x445x972mm	1 Year	100mm	260kg	43.8kg

**Drawer Capacities**

Top Shelf	Top Drawer (2)	Middle Drawer	Bottom Drawer	Bottom Shelf
90kg	13kg ea.	22kg	32kg	90kg

**WARNING****IMPORTANT: READ ALL INSTRUCTIONS BEFORE USE****WARNING**

The instructions and warnings contained in this manual should be read and understood before using or operating this equipment. Do not allow anyone to use or operate this equipment until they have read this manual and have developed a thorough understanding of how this equipment works. Failure to observe any of the instructions contained in the manual could result in severe personal injury to the user or bystanders, or cause damage to the equipment and property. Keep this manual in a convenient and safe place for future reference.

Whilst every effort has been made to ensure accuracy of information contained in this manual, the TQB Brands Pty Ltd policy of continuous improvement determines the right to make modifications without prior warning.

**CONTENT**

WARNING .....	2
CONTENT .....	2
SAFETY INSTRUCTIONS .....	3
ASSEMBLY, OPERATION, PREVENTITIVE MAINTENANCE .....	3
PARTS LIST .....	6
WARRANTY .....	7

## SAFETY INSTRUCTIONS



### SAFETY OPERATING INSTRUCTIONS

- Do not exceed the products rated maximum load capacity.
- Always distribute objects evenly on the Workshop Trolley. Uneven weight distribution could cause tipping.
- Do not lean or climb onto the Workshop Trolley.
- Only use this device for the purpose for which it has been designed.
- Do not modify any component of this equipment.
- When servicing, use only Tradequip identical replacement parts. Use of any other parts will void the warranty.
- Only use on a flat surface capable of supporting the Workshop Trolley and its rated maximum capacity load. It is easy to lose control of the Workshop Trolley if attempting to pull a load on a sloping or uneven surface.
- Use the right product for the job. There are certain applications for which the Workshop Trolley was designed. Do not modify the Workshop Trolley and do not use the Workshop Trolley for a purpose for which it was not intended.

## ASSEMBLY, OPERATION, PREVENTITIVE MAINTENANCE

### 1. FEATURES

The Tradequip 4 Drawer Workshop Trolley keep the tools you need for the job organised and easily accessible in its all-steel design. This mobile cart provides 6200 cu. in. of storage space and handles up to 260kg worth of tools, parts and equipment. Features include four smooth rolling swivel castors for easy manoeuvrability around your work area and a glossy powder coat finish for durability. A great mobile tool storage for any garage or workshop, this piece of kit is widely used for collecting and storing parts and/or tools when servicing vehicles and machinery etc.

### 2. ASSEMBLY

**Unpacking:** after removing the packing material, make sure the product is in perfect condition and that there are no visible damaged parts. The packaging materials (Polyethylene bags, polystyrene etc.), should be disposed of responsibly in an appropriate refuse collection container. These materials must not be left within the reach of children as they are potential sources of danger.

**Assemble the Cart:**

1. Assemble on a flat, level, hard and smooth surface capable of safely supporting a fully loaded Trolley.
2. Attach two Swivel Castors (12) to one side of the Bottom Shelf (11), using eight sets of Hex Bolts (13), Spring Washers (3) and Nuts (4). (Figure A)
3. Attach two Locking Swivel Castors (10) to the other side, using eight sets of Hex Bolts (13), Spring Washers (3) and Nuts (4). (Figure A)
4. Attach a Cross Support (9) between two Right Posts (1), using one set of Bolts (2), Spring Washers (3) and Nuts (4). (Figure B)
5. Repeat with remaining Cross Support and two Left Posts (6). (Figure B)
6. Attach Posts with Cross Supports to the outside corners of the Bottom Shelf, using sixteen sets of Bolts (2), Spring Washers (3) and Nuts (4). (Figure C)
- Warning! The chest is heavy; do not attempt to lift and lower onto Cross Supports without assistance.**
7. With assistance, lift up the chest, then lower it carefully between the Posts until its bottom edges rest on the Cross Supports. (Figure D)
8. Attach the Handle (7) to lower holes on same side as Locking Swivel Castors, using two Handle Bolts (8) and two Nuts (4). (Figure D)
9. Secure Posts to chest with fourteen sets of Bolts (2), Spring Washers (3) and Nuts (4).
10. Tighten and secure all hardware nuts and bolts.

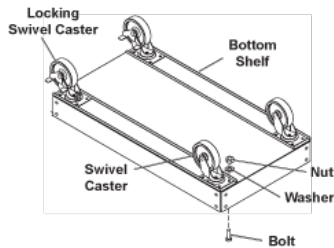

Figure A

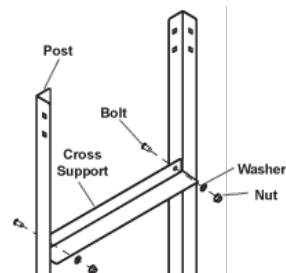

Figure B

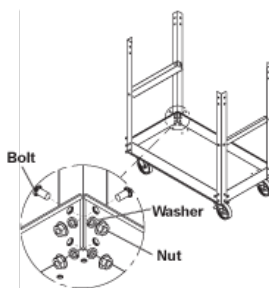

Figure C

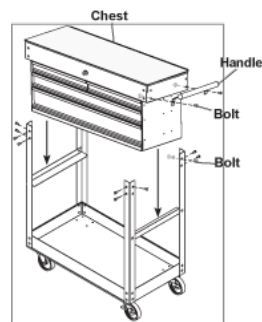

Figure D

*Your Workshop Trolley is ready for use.*

**Warning - Do not exceed the product's rated maximum load capacity.**

### **3. BEFORE USE**

Prior to each use conduct a visual inspection by checking for abnormal conditions, such as cracked joints and damaged, loose, or missing parts.

### **4. STORAGE**

This Workshop Trolley should always be stored in a dry location on a level surface.

### **5. MAINTENANCE**

Inspect the general condition of the Workshop Trolley checking:

- for loose hardware
- misalignment of binding or parts, cracked, bent, or broken parts, and
- any other condition that may affect the Workshop Trolleys safe operation.
- Clean the Workshop Trolley after each use. Ensure dirt, oil, grease and debris are not on the Workshop Trolley.

### **6. SERVICE & REPAIR**

Any 32 Bin Polyethylene Workshop Trolley found damaged in any way, or found to be worn or operates abnormally should be removed from service until repaired by an authorised service agent. Owners and / or operators should be aware that repair of this product may require specialised equipment and knowledge. Only authorised parts, labels, decals shall be used on this equipment. Annual inspection of the 32 Bin Polyethylene Workshop Trolley is recommended and can be made by an authorised repair facility to ensure that your equipment is in optimum condition and that the equipment has the correct decals and safety labels specified by the manufacturer.

## PARTS LIST

Part #	Description	QTY
1	Right Post	2
2	Bolt (M8 x 12)	34
3	Spring Washer	52
4	Nut	52
5	Chest	1
6	Left Post	2
7	Handle	1

Part #	Description	QTY
8	Handle Bolt (M8 x 16)	2
9	Cross Support	2
10	Locking Swivel Castor	2
11	Bottom Shelf	1
12	Castor Wheel	2
13	Hex Bolt (M8 x 16)	4

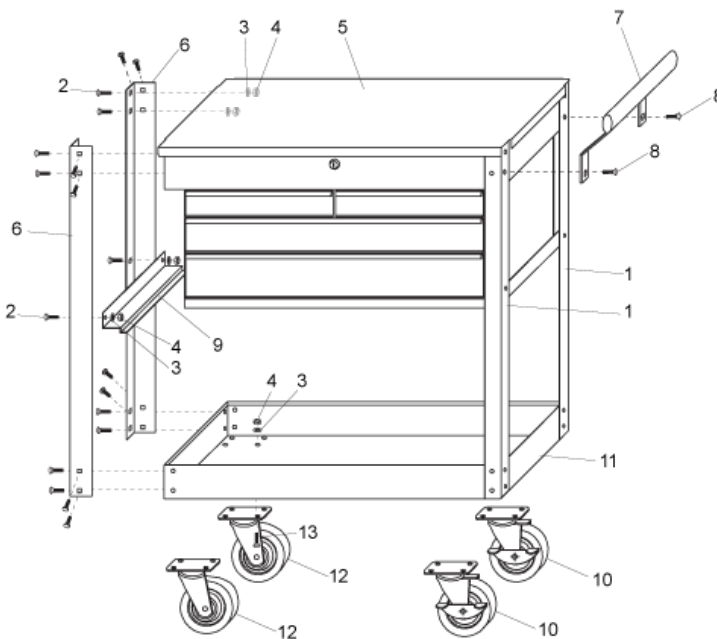

## WARRANTY

Tradequip products have been carefully tested and inspected before shipment and are guaranteed to be free from defective materials and workmanship for a period of 12 months from the date of purchase except where tools are hired out when the guarantee period is ninety days from the date of purchase.

Should this equipment develop any fault, please return the complete tool to your nearest authorised warranty repair agent or contact TQB Brands Pty Ltd Warranty team – [warranty@tqbbrands.com.au](mailto:warranty@tqbbrands.com.au).

If upon inspection it is found that the fault occurring is due to defective materials or workmanship, repairs will be carried out free of charge. This guarantee does not apply to normal wear and tear, nor does it cover any damage caused by misuse, careless or unsafe handling, alterations, accident, or repairs attempted or made by any personnel other than the authorised TQB Brands Pty Ltd repair agent.

This guarantee applies in lieu of any other guarantee expressed or implied and variations of its terms are not authorised.

Your TQB Brands Pty Ltd guarantee is not effective unless you can produce upon request a dated receipt or invoice to verify your proof of purchase within the 12 month period.

### **Consumer Guarantee**

Our goods come with a guarantee that cannot be excluded under the Australian Consumer aw. You are entitled to a replacement or refund for a major failure and compensation for any other reasonably foreseeable loss or damage. You are also entitled to have the goods repaired or replaced if the goods fail to be of acceptable quality and the failure does not amount to a major failure.



TQB Brands Pty Ltd

1/40 Metrolink Circuit  
Campbellfield  
Victoria  
3061

[sales@tqbbrands.com.au](mailto:sales@tqbbrands.com.au)