

DN 6 to 25
WP 350 bar

- Flow performance optimized by CFD
- Low leak-oil rates, eco-friendly
- Robust, compact and lightweight
- Extended temperature range

Patent Pending

TOP COAT



ARGUS flat face quick release couplings are used for quick coupling and uncoupling of hydraulic lines. During the coupling action in zero or low-pressure ranges, valves that release or block the flow are automatically activated. The FPK flat face quick release coupling, formed by a coupling plug and a coupling socket, is coupled by pushing on a sleeve. This guarantees a flush connection between the two coupling halves. The sleeve is designed to be moved in the relevant direction for disconnecting or connecting the coupling halves. A safety system against accidental uncoupling is present on the female part.

Materials

Galvanised steel with hardened parts subject to wear.
HNBR seals (other materials on request) – backup rings PTFE – Polyethylene dust cap and dust plug.
TOP COAT Cr-III zinc plating with additional trivalent passivation for outstanding surface protection.

Suitable for fluid lines with mineral oil based hydraulic fluids according DIN 51524 T1+T2. Also available for flame-resistant hydraulic fluids to VDMA 24317, for pneumatics and water hydraulics in appropriate materials on request.

Temperature range:
from -30 °C to +125 °C.

Additionally to the connection threads shown in the following tables, further types and sizes are available on request.
Specific instructions for installation, use and maintenance are separately provided.

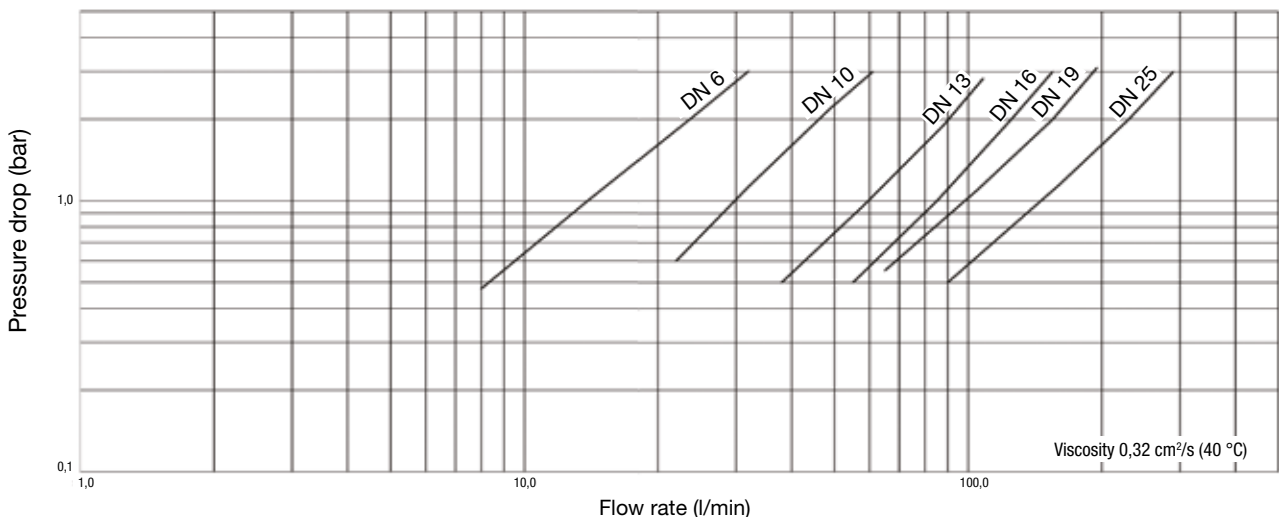

Values obtained with the same nominal size of coupling and connection (e.g. coupling 1/2", connection BSP 1/2"). For the evaluation of the actual pressure drops and for the comparison among different quick couplings, it is strictly needed to be aware of the test conditions those values have been determined at.

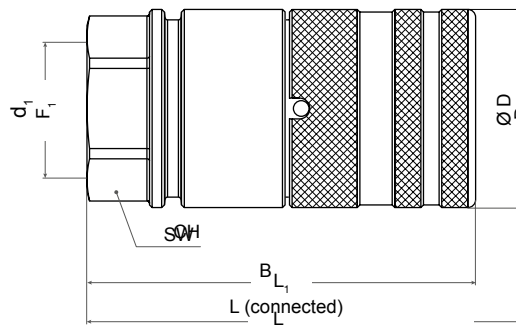

STANDARD ISO 16028 - Flat face FPK

Female coupling - female thread

Item Code	Part Number	DASH		DN	inch	WP Conn./ disconn. MPa	Min BP Conn./ disconn. MPa	Thread	d ₁ inch/ mm	B mm	Ø D mm	L mm	SW mm
1229101	R1Q-1229101	-4	6	1/4	35	140	BSPP	1/4	57,8	26	97	22	
1229102	R1Q-1229102	-6	10	3/8	35	140	BSPP	3/8	71,3	32	119	27	
1224380	R1Q-1224380	-6	10	3/8	35	140	BSPP	1/2	71,3	32	119	27	
1229103	R1Q-1229103	-8	13	1/2	35	140	BSPP	1/2	74,5	38	125	32	
1224381	R1Q-1224381	-8	13	1/2	35	140	BSPP	3/4	74,5	38	125	32	
1232287	R1Q-1232287	-10	16	5/8	35	140	BSPP	3/4	81,3	40	134	34	
1229105	R1Q-1229105	-12	19	3/4	35	140	BSPP	3/4	93	48	156	42	
1224382	R1Q-1224382	-12	19	3/4	35	140	BSPP	1	93	48	156	42	
1231464	R1Q-1231464	-16	25	1	35	140	BSPP	1	101	55	177	50	
1229106	R1Q-1229106	-16	25	1	35	140	BSPP	1 1/4	101	55	177	50	
1229213	R1Q-1229213	-4	6	1/4	35	140	NPTF	1/4	57,8	26	97	22	
1229214	R1Q-1229214	-6	10	3/8	35	140	NPTF	3/8	71,3	32	119	27	
1229215	R1Q-1229215	-6	10	3/8	35	140	NPTF	1/2	71,3	32	119	27	
1229216	R1Q-1229216	-8	13	1/2	35	140	NPTF	1/2	74,5	38	125	32	
1229217	R1Q-1229217	-8	13	1/2	35	140	NPTF	3/4	74,5	38	125	32	
1232382	R1Q-1232382	-10	16	5/8	35	140	NPTF	3/4	81,3	40	134	34	
1229219	R1Q-1229219	-12	19	3/4	35	140	NPTF	3/4	93	48	156	42	
1232460	R1Q-1232460	-12	19	3/4	35	140	NPTF	1	93	48	156	42	
1231467	R1Q-1231467	-16	25	1	35	140	NPTF	1	101	55	177	50	
1233075	R1Q-1233075	-16	25	1	35	140	NPTF	1 1/4	101	55	177	50	
1233978	R1Q-1233978	-4	6	1/4	35	140	SAE/UNF	7/16 -20	57,8	26	97	22	
1229236	R1Q-1229236	-6	10	3/8	35	140	SAE/UNF	9/16 -18	69,3	32	117	27	
1229238	R1Q-1229238	-8	13	1/2	35	140	SAE/UNF	3/4 -16	74,5	38	125	32	
1232384	R1Q-1232384	-10	16	5/8	35	140	SAE/UN	1 1/16-12	81,3	40	134	34	
1229241	R1Q-1229241	-12	19	3/4	35	140	SAE/UN	1 1/16-12	93	48	156	42	
1229243	R1Q-1229243	-16	25	1	35	140	SAE/UN	1 5/16-12	101	55	177	50	
1231469	R1Q-1231469	-6	10	3/8	35	140	MET	M22x1,5	69,3	32	117	27	

BSPP connection according to DIN 3852-2-X, NPTF connection according to ANSI B1-20.3, metric connection according to ISO 6149-1, SAE UNF/UN connection according to SAE J 1926-1.

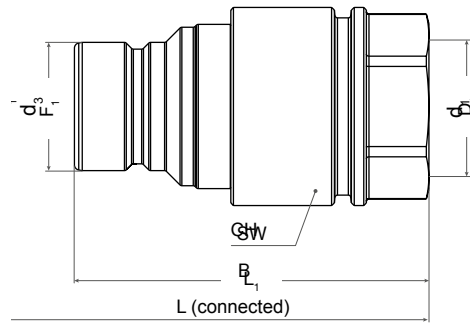
STANDARD ISO 16028 - Flat face FPK
Male coupling - female thread

Item Code	Part Number				WP Conn./ disconn. MPa	Min BP Conn./ disconn. MPa	Thread	d ₁ inch/ mm	B mm	d ₃ mm	L mm	SW mm
		DASH	DN	inch								
1229109	R1Q-1229109	-4	6	1/4	35	140	BSPP	1/4	50,5	16,2	97	20
1229110	R1Q-1229110	-6	10	3/8	35	140	BSPP	3/8	64	19,7	119	27
1229111	R1Q-1229111	-6	10	3/8	35	140	BSPP	1/2	64	19,7	119	27
1229112	R1Q-1229112	-8	13	1/2	35	140	BSPP	1/2	68	24,6	125	32
1224377	R1Q-1224377	-8	13	1/2	35	140	BSPP	3/4	68	24,6	125	32
1232288	R1Q-1232288	-10	16	5/8	35	140	BSPP	3/4	70	27	134	34
1229113	R1Q-1229113	-12	19	3/4	35	140	BSPP	3/4	85	29,9	156	42
1224378	R1Q-1224378	-12	19	3/4	35	140	BSPP	1	85	29,9	156	42
1231463	R1Q-1231463	-16	25	1	35	140	BSPP	1	99	36	177	50
1229114	R1Q-1229114	-16	25	1	35	140	BSPP	1 1/4	99	36	177	50
1229224	R1Q-1229224	-4	6	1/4	35	140	NPTF	1/4	50,5	16,2	97	20
1229225	R1Q-1229225	-6	10	3/8	35	140	NPTF	3/8	64	19,7	119	27
1229226	R1Q-1229226	-6	10	3/8	35	140	NPTF	1/2	64	19,7	119	27
1229227	R1Q-1229227	-8	13	1/2	35	140	NPTF	1/2	68	24,6	125	32
1229228	R1Q-1229228	-8	13	1/2	35	140	NPTF	3/4	68	24,6	125	32
1232383	R1Q-1232383	-10	16	5/8	35	140	NPTF	3/4	70	27	134	34
1229230	R1Q-1229230	-12	19	3/4	35	140	NPTF	3/4	85	29,9	156	42
1232461	R1Q-1232461	-12	19	3/4	35	140	NPTF	1	85	29,9	156	42
1231466	R1Q-1231466	-16	25	1	35	140	NPTF	1	99	36	177	50
1233076	R1Q-1233076	-16	25	1	35	140	NPTF	1 1/4	99	36	177	50
1233980	R1Q-1233980	-4	6	1/4	35	140	SAE/UNF	7/16 -20	50,5	16,2	97	20
1229247	R1Q-1229247	-6	10	3/8	35	140	SAE/UNF	9/16 -18	64	19,7	117	27
1229249	R1Q-1229249	-8	13	1/2	35	140	SAE/UNF	3/4 -16	68	24,6	125	32
1232385	R1Q-1232385	-10	16	5/8	35	140	SAE/UN	1 1/16-12	70	27	134	34
1229252	R1Q-1229252	-12	19	3/4	35	140	SAE/UN	1 1/16-12	85	29,9	156	42
1229254	R1Q-1229254	-16	25	1	35	140	SAE/UN	1 5/16-12	99	36	177	50
1231468	R1Q-1231468	-6	10	3/8	35	140	MET	M22x1,5	64	19,7	117	27

BSPP connection according to DIN 3852-2-X, NPTF connection according to ANSI B1-20.3, metric connection according to ISO 6149-1, SAE UNF/UN connection according to SAE J 1926-1.

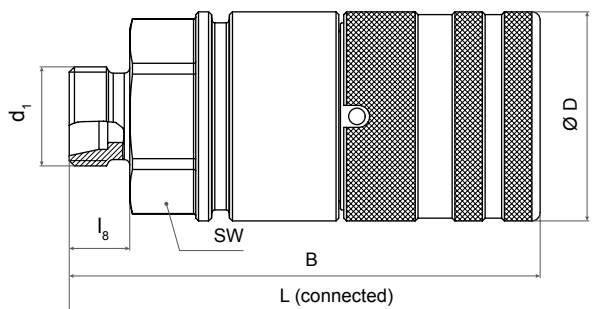
STANDARD ISO 16028 - Flat face FPK
Female coupling - metric 24° light/heavy series

Item Code	Part Number				WP Conn./ disconn. MPa	Min BP Conn./ disconn. MPa	Thread	RA mm	d ₁ mm	B mm	Ø D mm	L mm	l ₈ mm	SW mm
		DASH	DN	inch										
1234726	R1Q-341975	-4	6	1/4	35	140	D24L	8	M14x1,5	67,7	26	117,2	10	22
1229118	R1Q-341977	-6	10	3/8	35	140	D24L	10	M16x1,5	82,3	32	141,4	11	27
1223449	R1Q-341978	-6	10	3/8	35	140	D24L	12	M18x1,5	82,3	32	141,4	11	27
1234030	R1Q-341979	-6	10	3/8	35	140	D24L	15	M22x1,5	83,3	32	143,4	12	27
1223438	R1Q-341980	-8	13	1/2	35	140	D24L	12	M18x1,5	85,6	38	147,2	11	32
1223440	R1Q-341981	-8	13	1/2	35	140	D24L	15	M22x1,5	86,6	38	149,2	12	32
1229120	R1Q-341985	-12	19	3/4	35	140	D24L	18	M26x1,5	105,0	48	180	12	42
1229121	R1Q-341986	-12	19	3/4	35	140	D24L	22	M30x2,0	107	48	184	14	42
1234031	R1Q-341987	-16	25	1	35	140	D24L	22	M30x2,0	115	55	204,9	14	50
1229122	R1Q-341988	-16	25	1	35	140	D24L	28	M36x2,0	115	55	204,9	14	50
1234032	R1Q-341991	-4	6	1/4	35	140	D24S	8	M16x1,5	69,7	26	121,2	12	22
1234033	R1Q-341992	-6	10	3/8	35	140	D24S	12	M20x1,5	83,3	32	143,4	12	27
1234034	R1Q-341993	-6	10	3/8	35	140	D24S	14	M22x1,5	85,3	32	147,4	14	27
1234035	R1Q-341994	-6	10	3/8	35	140	D24S	16	M24x1,5	85,3	32	147,4	14	27
1229153	R1Q-341995	-8	13	1/2	35	140	D24S	14	M22x1,5	88,6	38	153,2	14	32
1234036	R1Q-341996	-8	13	1/2	35	140	D24S	16	M24x1,5	88,6	38	153,2	14	32
1229156	R1Q-342000	-12	19	3/4	35	140	D24S	20	M30x2,0	109	48	188	16	42
1234037	R1Q-342001	-12	19	3/4	35	140	D24S	25	M36x2,0	111	48	192	18	42
1234038	R1Q-342002	-12	19	3/4	35	140	D24S	30	M42x2,0	113	48	196	20	46
1229157	R1Q-342003	-16	25	1	35	140	D24S	25	M36x2,0	119	55	212,9	18	50
1234039	R1Q-342004	-16	25	1	35	140	D24S	30	M42x2,0	117	56	216,9	20	50

Metric connection according to DIN EN ISO 8434-1.

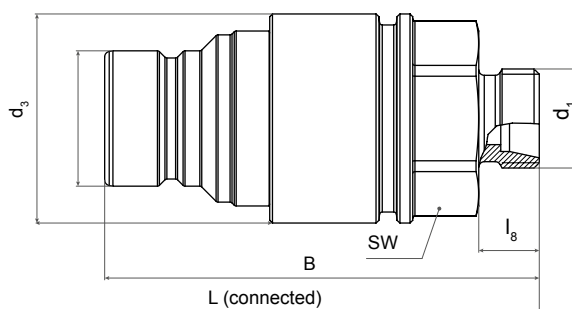
STANDARD ISO 16028 - Flat face FPK
Male coupling - metric 24° light/heavy series

Item Code	Part Number	↔		WP Conn./ disconn. MPa	Min BP Conn./ disconn. MPa	Thread	RA mm	d ₁ mm	B mm	d ₃ mm	L mm	l ₈ mm	d ₄ mm	SW mm	
		DASH	DN												inch
1234727	R1Q-341945	-4	6	1/4	35	140	D24L	8	M14x1,5	60,5	16,2	117,2	10	26	22
1234728	R1Q-341947	-6	10	3/8	35	140	D24L	10	M16x1,5	75,0	19,7	141,4	11	32	27
1223471	R1Q-341948	-6	10	3/8	35	140	D24L	12	M18x1,5	75,0	19,7	141,4	11	32	27
1234040	R1Q-341949	-6	10	3/8	35	140	D24L	15	M22x1,5	76,0	19,7	143,4	12	32	27
1223453	R1Q-341950	-8	13	1/2	35	140	D24L	12	M18x1,5	79,0	24,6	147,2	11	38	32
1222555	R1Q-341951	-8	13	1/2	35	140	D24L	15	M22x1,5	80,0	24,6	149,2	12	38	32
1229128	R1Q-341955	-12	19	3/4	35	140	D24L	18	M26x1,5	97,0	29,9	180	12	48	42
1229129	R1Q-341956	-12	19	3/4	35	140	D24L	22	M30x2,0	99	29,9	184	14	48	42
1234041	R1Q-341957	-16	25	1	35	140	D24L	22	M30x2,0	113	36	204,9	14	55	50
1229130	R1Q-341958	-16	25	1	35	140	D24L	28	M36x2,0	113	36	204,9	14	55	50
1234042	R1Q-341961	-4	6	1/4	35	140	D24S	8	M16x1,5	62,5	16,2	121,2	12	26	22
1234043	R1Q-341962	-6	10	3/8	35	140	D24S	12	M20x1,5	76,0	19,7	143,4	12	32	27
1234044	R1Q-341963	-6	10	3/8	35	140	D24S	14	M22x1,5	78,0	19,7	147,4	14	32	27
1234045	R1Q-341964	-6	10	3/8	35	140	D24S	16	M24x1,5	78,0	19,7	147,4	14	32	27
1223461	R1Q-341965	-8	13	1/2	35	140	D24S	14	M22x1,5	82,0	24,6	153,2	14	38	32
1234046	R1Q-341966	-8	13	1/2	35	140	D24S	16	M24x1,5	82,0	24,6	153,2	14	38	32
1229166	R1Q-341970	-12	19	3/4	35	140	D24S	20	M30x2,0	101	29,9	188	16	48	42
1234047	R1Q-341971	-12	19	3/4	35	140	D24S	25	M36x2,0	103	29,9	192	18	48	42
1234048	R1Q-341972	-12	19	3/4	35	140	D24S	30	M42x2,0	105	29,9	196	20	52	46
1229167	R1Q-341973	-16	25	1	35	140	D24S	25	M36x2,0	117	36	212,9	18	55	50
1234049	R1Q-341974	-16	25	1	35	140	D24S	30	M42x2,0	119	36	216,9	20	55	50

Metric connection according to DIN EN ISO 8434-1.

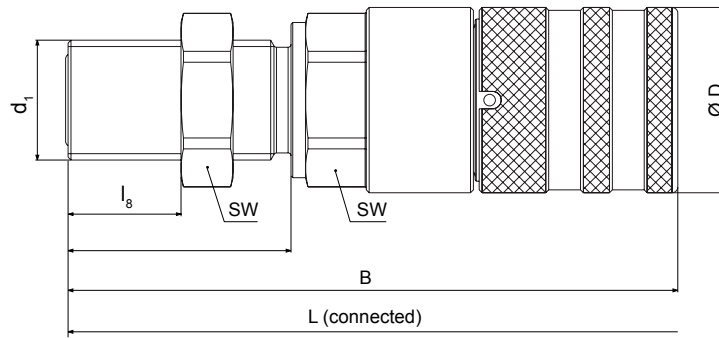

STANDARD ISO 16028 - Flat face FPK

Female coupling - bulkhead thread

Item Code	Part Number				WP Conn./ disconn. MPa	Min BP Conn./ disconn. MPa	Thread	d_1 mm	B mm	$\varnothing D$ mm	L mm	l_8 mm	SW mm
		DASH	DN	inch									
1234706	R1Q-1234706	-6	10	3/8	35	140	ORFS	3/16	105,3	32	187,5	38,5	27
1239546	R1Q-1239546	-8	13	1/2	35	140	ORFS	1	106,6	38	193,7	40,5	34

STANDARD ISO 16028 - Flat face FPK

Red dust cap for female coupling

Item Code	Part Number	DASH	DN	inch
1224407	RT-1224407	-4	6	1/4
1224408	RT-1224408	-6	10	3/8
1224409	RT-1224409	-8	13	1/2
1223544	RT-1223544	-10	16	5/8
1223537	RT-1223537	-12	19	3/4
1223539	RT-1223539	-16	25	1

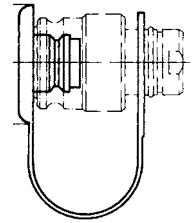

STANDARD ISO 16028 - Flat face FPK

Red dust cap for male coupling

Item Code	Part Number	DASH	DN	inch
1223532	RT-1223532	-4	6	1/4
1223536	RT-1223536	-6	10	3/8
1223531	RT-1223531	-8	13	1/2
1223535	RT-1223535	-10	16	5/8
1223528	RT-1223528	-12	19	3/4
1223530	RT-1223530	-16	25	1

