

DN 6 to 51
to max. WP 350 bar

- **Quick and simple coupling and uncoupling**
- **Cost effective**



ARGUS ISO 7241-1 series “A” quick release couplings are used for quick coupling and uncoupling of hydraulic lines. During the coupling action in zero or low-pressure ranges, valves that release or block the flow are automatically activated.

The SVK-ISO-A quick release coupling, formed by the coupling plug and the coupling socket, is connected by pushing on a sleeve.

This guarantees a flush connection between the two coupling halves.

Materials

Galvanised steel with hardened parts subject to wear – NBR O-rings (other materials optional) – Polyethylene dust cap and dust plug.

Cr-III zinc plating through additional passivation for improved surface protection (TOP COAT for metric version).

Suitable for liquid lines with mineral oil-based hydraulic fluids to DIN 51524 T1+T2.

Temperature range:

from -20 °C to +100 °C.

from -30 °C to +125 °C (metric version).

Specific instructions for installation, use and maintenance are separately provided.

Rated flow / pressure drop compliant with ISO 7241-1 standard.

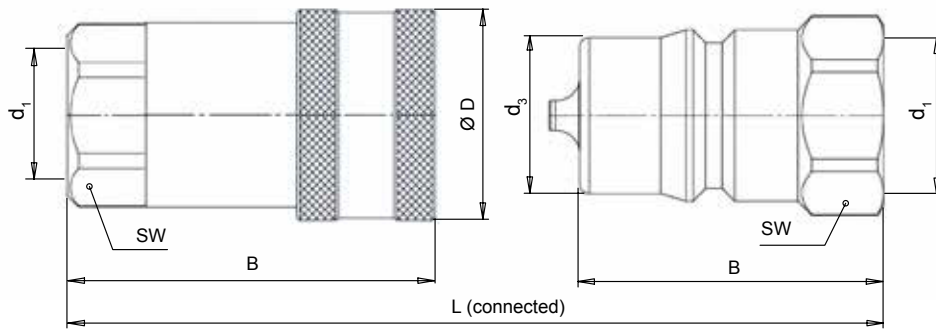
STANDARD ISO 7241 A - Poppet SVK-ISO-A
Female coupling - female thread

Item Code	Part Number				WP Conn./ disconn. MPa	Min BP Conn./ disconn. MPa	Thread	d ₁ inch	B mm	ø D mm	L mm	SW mm
		DASH	DN	inch								
1219613	R1QEPAF06F-0404	-4	6	1/4	35	140	BSPP	1/4	50	26	74,2	19
1219607	R1QEPAF06F-0606	-6	10	3/8	31,5	126	BSPP	3/8	56	31,5	78,5	22
1232129	R1QEPAF06F-0608	-6	10	3/8	31,5	126	BSPP	1/2	56	32	74,5	27
1219617	R1QEPAF06F-0808	-8	13	1/2	27	108	BSPP	1/2	66	38,5	88,2	27
1219609	R1QEPAF06F-1212	-12	19	3/4	25	100	BSPP	3/4	82,5	48	110,4	34
1219619	R1QEPAF06F-1616	-16	25	1	20	80	BSPP	1	100	56	132,9	41
1223504	R1QEPAF06F-2020	-20	32	1 1/4	20	80	BSPP	1 1/4	117	70	150	50
1219620	R1QEPAF06F-2424	-24	40	1 1/2	16	64	BSPP	1 1/2	133	84,5	167	60
1223392	R1QEPAF06F-3232	-32	51	2	10	40	BSPP	2	165	99	210	75
1219612	R1QEPAF28F-0404	-4	6	1/4	35	140	NPTF	1/4	50	26	74,2	19
1222491	R1QEPAF28F-0606	-6	10	3/8	31,5	126	NPTF	3/8	57,1	31,5	78,5	22
1222488	R1QEPAF28F-0808	-8	13	1/2	27	108	NPTF	1/2	66	38,5	88,2	27
1222494	R1QEPAF28F-1212	-12	19	3/4	25	100	NPTF	3/4	82,5	48	110,4	34
1222495	R1QEPAF28F-1616	-16	25	1	20	80	NPTF	1	100	56	132,9	41
1229489	R1QEPAF28F-2424	-24	40	1 1/2	16	64	NPTF	1 1/2	133	84,5	167	60
1229490	R1QEPAF28F-3232	-32	51	2	10	40	NPTF	2	165	99	210	75

BSPP connection according to DIN 3852-2-X, NPTF connection according to ANSI B1-20.3, metric connection according to ISO 6149-1.

STANDARD ISO 7241 A - Poppet SVK-ISO-A
Male coupling - female thread

Item Code	Part Number				WP Conn./ disconn. MPa	Min BP Conn./ disconn. MPa	Thread	d ₁ inch	B mm	d ₃ mm	L mm	SW mm
		DASH	DN	inch								
1219611	R1QEPAM06F-0404	-4	6	1/4	35	140	BSPP	1/4	38,5	11,8	74,2	19
1219606	R1QEPAM06F-0606	-6	10	3/8	31,5	126	BSPP	3/8	36,5	17,3	78,5	22
1219615	R1QEPAM06F-0808	-8	13	1/2	27	108	BSPP	1/2	44	20,5	88,2	27
1219608	R1QEPAM06F-1212	-12	19	3/4	25	100	BSPP	3/4	55	29	110,4	34
1219618	R1QEPAM06F-1616	-16	25	1	20	80	BSPP	1	66	34,3	132,9	41
1223512	R1QEPAM06F-2020	-20	32	1 1/4	20	80	BSPP	1 1/4	75	45	150	50
1223511	R1QEPAM06F-2424	-24	40	1 1/2	16	64	BSPP	1 1/2	83,5	55	167	60
1223395	R1QEPAM06F-3232	-32	51	2	10	40	BSPP	2	105	65	210	75
1219610	R1QEPAM28F-0404	-4	6	1/4	35	140	NPTF	1/4	38,5	11,8	74,2	19
1222492	R1QEPAM28F-0606	-6	10	3/8	31,5	126	NPTF	3/8	39	17,3	78,5	22
1222489	R1QEPAM28F-0808	-8	13	1/2	27	108	NPTF	1/2	44	20,5	88,2	27
1222490	R1QEPAM28F-1212	-12	19	3/4	25	100	NPTF	3/4	55	29	110,4	34
1222487	R1QEPAM28F-1616	-16	25	1	20	80	NPTF	1	66	34,3	132,9	41
1229496	R1QEPAM28F-2424	-24	40	1 1/2	16	64	NPTF	1 1/2	83,5	55	167	60
1229497	R1QEPAM28F-3232	-32	51	2	10	40	NPTF	2	105	65	210	75

BSPP connection according to DIN 3852-2-X, NPTF connection according to ANSI B1-20.3, metric connection according to ISO 6149-1.

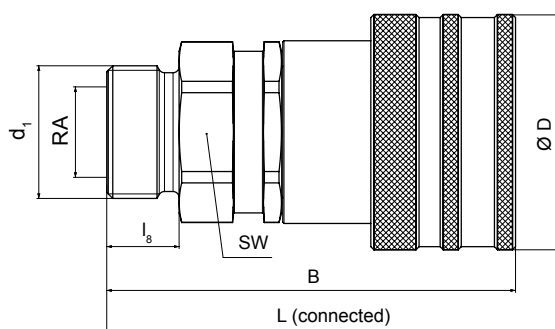

STANDARD ISO 7241 A - Poppet SVK-ISO-A

Female coupling - metric 24° light/heavy series

Item Code	Part Number	Metric connection according to DIN EN ISO 8434-1			WP Conn./ disconn. MPa	Min BP Conn./ disconn. MPa	Thread	RA mm	d ₁ mm	B mm	ø D mm	L mm	I ₈ mm	SW mm
		DASH	DN	inch										
1233909	R1Q-341849	-4	6	1/4	35	140	D24L	6	M12x1,5	52	25	84,6	10	19
1229374	R1Q-341850	-4	6	1/4	35	140	D24L	8	M14x1,5	52	25	84,6	10	19
1233910	R1Q-341852	-6	10	3/8	31,5	126	D24L	8	M14x1,5	49,5	32	89,7	10	22
1229375	R1Q-341853	-6	10	3/8	31,5	126	D24L	10	M16x1,5	50,5	32	91,7	11	22
1233925	R1Q-341854	-8	13	1/2	27	108	D24L	8	M14x1,5	65,8	39	100,1	10	27
1233927	R1Q-341855	-8	13	1/2	27	108	D24L	10	M16x1,5	66,8	39	102,1	11	27
1229377	R1Q-341856	-8	13	1/2	27	108	D24L	12	M18x1,5	66,8	39	102,1	11	27
1229378	R1Q-341857	-8	13	1/2	27	108	D24L	15	M22x1,5	67,8	39	104,1	12	27
1233928	R1Q-341858	-8	13	1/2	27	108	D24L	18	M26x1,5	67,8	39	104,1	12	32
1233929	R1Q-341859	-12	19	3/4	25	100	D24L	12	M18x1,5	80	46	117,9	11	36
1233930	R1Q-341860	-12	19	3/4	25	100	D24L	15	M22x1,5	81	46	119,9	12	36
1229380	R1Q-341861	-12	19	3/4	25	100	D24L	18	M26x1,5	81	46	119,9	12	36
1229381	R1Q-341862	-12	19	3/4	25	100	D24L	22	M30x2,0	83	46	123,9	14	36
1233931	R1Q-341863	-16	25	1	20	80	D24L	18	M26x1,5	94	52	137,4	12	41
1233932	R1Q-341864	-16	25	1	20	80	D24L	22	M30x2,0	96	52	141,4	14	41
1229382	R1Q-341865	-16	25	1	20	80	D24L	28	M36x2,0	96	52	141,4	14	41
1233933	R1Q-341866	-16	25	1	20	80	D24L	35	M45x2,0	98	52	145,4	16	50
1233934	R1Q-341867	-6	10	3/8	31,5	126	D24S	8	M16x1,5	51,5	32	93,7	12	22
1233935	R1Q-341868	-6	10	3/8	31,5	126	D24S	10	M18x1,5	51,5	32	93,7	12	22
1229419	R1Q-341869	-6	10	3/8	31,5	126	D24S	12	M20x1,5	51,5	32	93,7	12	22
1233936	R1Q-341870	-8	13	1/2	27	108	D24S	10	M18x1,5	67,8	39	104,1	12	27
1233937	R1Q-341871	-8	13	1/2	27	108	D24S	12	M20x1,5	67,8	39	104,1	12	27
1233938	R1Q-341872	-8	13	1/2	27	108	D24S	14	M22x1,5	67,8	39	104,1	12	27
1229422	R1Q-341873	-8	13	1/2	27	108	D24S	16	M24x1,5	69,8	39	108,1	14	27
1233939	R1Q-341874	-12	19	3/4	25	100	D24S	16	M24x1,5	83	46	123,9	14	36
1233940	R1Q-341875	-12	19	3/4	25	100	D24S	20	M30x2,0	85	46	127,9	16	36
1234911	R1Q-341734	-12	19	3/4	25	100	D24S	25	M36x2,0	87	46	131,9	18	36
1233941	R1Q-341876	-16	25	1	20	80	D24S	20	M30x2,0	98	53	145,4	16	41
1229426	R1Q-341877	-16	25	1	20	80	D24S	25	M36x2,0	100	53	149,4	18	41
1233942	R1Q-341878	-16	25	1	20	80	D24S	30	M42x2,0	102	53	153,4	20	41
1233943	R1Q-341879	-16	25	1	20	80	D24S	38	M52x2,0	104	53	157,4	22	55

Metric connection according to DIN EN ISO 8434-1.

For related male coupling see page 26.

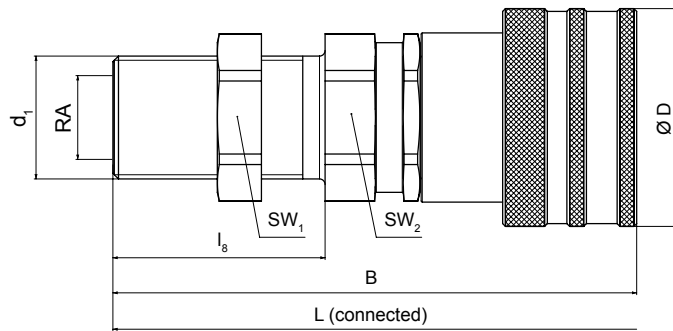

STANDARD ISO 7241 A - Poppet SVK-ISO-A

Female coupling - metric 24° light series bulkhead

Item Code	Part Number				WP Conn./ disconn. MPa	Min BP Conn./ disconn. MPa	Thread	RA mm	d ₁ mm	B mm	ø D mm	L mm	I ₈ mm	SW ₁ mm	SW ₂ mm
		DASH	DN	inch											
1233955	R1Q-341897	-4	6	1/4	35	140	D24L	6	M12x1,5	76	25	132,6	34	19	17
1229396	R1Q-341898	-4	6	1/4	35	140	D24L	8	M14x1,5	76	25	132,6	34	19	19
1233956	R1Q-341899	-6	10	3/8	31,5	126	D24L	8	M14x1,5	82	32	137,7	34	22	19
1229397	R1Q-341900	-6	10	3/8	31,5	126	D24L	10	M16x1,5	83	32	139,7	35	22	22
1233957	R1Q-341902	-8	13	1/2	27	108	D24L	8	M14x1,5	89,8	38	148,1	34	27	19
1233958	R1Q-341903	-8	13	1/2	27	108	D24L	10	M16x1,5	90,8	38	150,1	35	27	22
1229399	R1Q-341904	-8	13	1/2	27	108	D24L	12	M18x1,5	91,8	38	152,1	36	27	24
1229400	R1Q-341905	-8	13	1/2	27	108	D24L	15	M22x1,5	93,8	38	156,1	38	27	30
1233959	R1Q-341906	-8	13	1/2	27	108	D24L	18	M26x1,5	95,8	38	160,1	40	32	36
1233960	R1Q-341907	-12	19	3/4	25	100	D24L	12	M18x1,5	105	45	167,9	36	36	24
1233961	R1Q-341908	-12	19	3/4	25	100	D24L	15	M22x1,5	107	45	171,9	38	36	30
1229402	R1Q-341909	-12	19	3/4	25	100	D24L	18	M26x1,5	109	45	175,9	40	36	36
1229403	R1Q-341910	-12	19	3/4	25	100	D24L	22	M30x2,0	111	45	179,9	42	36	41
1234912	R1Q-341735	-16	25	1	20	80	D24L	18	M26x2,0	122	52	193,4	40	41	36
1233962	R1Q-341911	-16	25	1	20	80	D24L	22	M30x2,0	124	52	197,4	42	41	41
1229404	R1Q-341912	-16	25	1	20	80	D24L	28	M36x2,0	125	52	199,4	43	41	46
1233963	R1Q-341913	-16	25	1	20	80	D24L	35	M45x2,0	129	52	207,4	47	50	55

Metric connection according to DIN EN ISO 8434-1.

For related male coupling see page 29.

STANDARD ISO 7241 A - Poppet SVK-ISO-A
Dust plug (for female coupling)

Item Code	Part Number	Colour			
			DASH	DN	inch
1219283	RT-1219283	Red	-4	6	1/4
1219281	RT-1219281	Red	-6	10	3/8
1219284	RT-1219284	Red	-8	13	1/2
1237767	RT-1237767	Green	-8	13	1/2
1224393	RT-1224393	Black	-8	13	1/2
1222514	RT-1222514	Blue	-8	13	1/2
1222515	RT-1222515	Yellow	-8	13	1/2
1219282	RT-1219282	Red	-12	19	3/4
1219285	RT-1219285	Red	-16	25	1

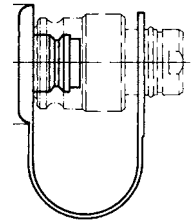
STANDARD ISO 7241 A - Poppet SVK-ISO-A
Dust cap (for male coupling)

Item Code	Part Number	Colour			
			DASH	DN	inch
1219446	RT-1219446	Red	-4	6	1/4
1239710	RT-1239710	Blue	-4	6	1/4
1219444	RT-1219444	Red	-6	10	3/8
1239711	RT-1239711	Blue	-6	10	3/8
1219447	RT-1219447	Red	-8	13	1/2
1237768	RT-1237768	Green	-8	13	1/2
1237769	RT-1237769	Black	-8	13	1/2
1224391	RT-1224391	Blue	-8	13	1/2
1222521	RT-1222521	Yellow	-8	13	1/2
1219445	RT-1219445	Red	-12	19	3/4
1239712	RT-1239712	Blue	-12	19	3/4
1219448	RT-1219448	Red	-16	25	1
1239713	RT-1239713	Blue	-16	25	1

