



**OWNER'S MANUAL**  
**PRODUCT CODE: 6045**

**POLYETHYLENE WORKSHOP TROLLEY**



Overall Size	Shelf Size	Castor	Capacity
1000x435x850mm	790mm x 430mm	100mm x 127mm Non Marking	226kg

WARNING

IMPORTANT: READ ALL INSTRUCTIONS BEFORE USE



WARNING

The instructions and warnings contained in this manual should be read and understood before using or operating this equipment. Do not allow anyone to use or operate this equipment until they have read this manual and have developed a thorough understanding of how this equipment works. Failure to observe any of the instructions contained in the manual could result in severe personal injury to the user or bystanders, or cause damage to the equipment and property. Keep this manual in a convenient and safe place for future reference.

Whilst every effort has been made to ensure accuracy of information contained in this manual, the TQB Brands Pty Ltd policy of continuous improvement determines the right to make modifications without prior warning.

CONTENT

WARNING .....2

CONTENT .....2

SAFETY INSTRUCTIONS .....3

ASSEMBLY, OPERATION, PREVENTITIVE MAINTENANCE .....3

PARTS LIST .....6

WARRANTY .....7

## SAFETY INSTRUCTIONS



### SAFETY OPERATING INSTRUCTIONS

- Do not exceed the products rated maximum load capacity.
- Always distribute objects evenly on the Workshop Trolley. Uneven weight distribution could cause tipping.
- Do not lean or climb onto the Workshop Trolley.
- Only use this device for the purpose for which it has been designed.
- Do not modify any component of this equipment.
- When servicing, use only Tradequip identical replacement parts. Use of any other parts will void the warranty.
- Only use on a flat surface capable of supporting the Workshop Trolley and its rated maximum capacity load. It is easy to lose control of the Workshop Trolley if attempting to pull a load on a sloping or uneven surface.
- Use the right product for the job. There are certain applications for which the Workshop Trolley was designed. Do not modify the Workshop Trolley and do not use the Workshop Trolley for a purpose for which it was not intended.

## ASSEMBLY, OPERATION, PREVENTITIVE MAINTENANCE

### 1. FEATURES

The Tradequip Polyethylene Workshop Trolley is widely used for collecting or storing parts or tools when servicing machinery and vehicles etc.

### 2. ASSEMBLY

**Unpacking:** after removing the packing material, make sure the product is in perfect condition and that there are no visible damaged parts. The packaging materials (Polyethylene bags, polystyrene etc.), must be disposed of in an appropriate refuse collection container. These materials must not be left within the reach of children as they are potential sources of danger.

#### Assembly:

1. Place one Tray (1A) upside down on the work surface. Locate the Handle (3). Turn it upside down with the hand holes on the outside away from the Tray (1A). Using a rubber mallet, tap the Handle (5) down into the grooves on the Tray (1A) - see Figure A.
2. Locate the two Beams (4). Place one on the Tray (1A) corner nearest the Handle (3), and place one on the diagonal corner located on the outside of the Tray (1A) as in the Assembly diagram. Make certain that the end with the screw holes is facing upward. Using a rubber mallet, tap the Beams (4) down into the Tray (1A). Note: Position the Beams so that the flange in each matches the space in the Tray (1A). Refer Figure B.

3. Locate the two Beams (5). Place one on the Tray (1A) corner nearest the Handle (3), and place one on the diagonal corner located on the outside of the Tray (1A) as in the Assembly diagram. Make certain that the end with the screw holes is facing upward. Using a rubber mallet, tap the Beams (5) down into the Tray (1A). Refer Figure B.
4. Inserts Screws (2) down through each Beam (4) and Beam (5) and into the Tray (1A) - Refer Figure B & C.
5. Locate the second Tray (1B) and turn it upside down. Set the second Tray (1B) onto the Beams (4 & 5), locate it in the middle of Beams, secure the Tray into the brackets on the Beams - Refer Figure C.
6. Locate the third Tray (1C) and turn it upside down. Set the third Tray (1C) onto the Beams (4 & 5) making certain that both Trays (1C) are facing the same way. Refer Figure D.
7. Turn the Workshop Trolley upside down. Attach two Castors (8) with the Swivel Castor Brackets (6) using Nut (7) and Screw (9) if necessary. Thread Screw (13) through the Tray (1C) and into the Castors (8). Attach one Split Washer (11) and one Nut (12) for each hole. Refer Figure E.
8. Attach another two Castors (8) to the Fixed Castor Brackets (10) using Nut (7) and Screw (9) if necessary. Thread Screw (13) through the Tray (1C) and into the Castors (8). Attach one Split Washer (11) and one Nut (12) for each hole. Refer Figure E.
9. Turn the Workshop Trolley upright. Make certain that all hardware is tight. Make certain that the Fixed Castors and Swivel Castors roll properly.

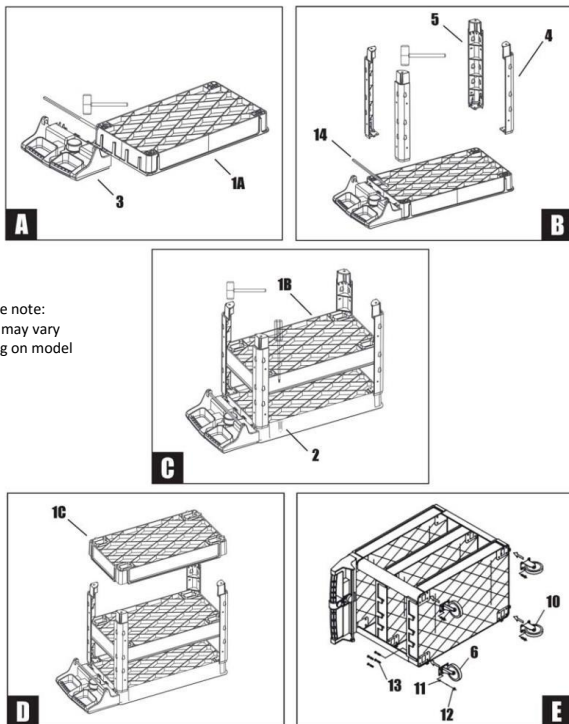

Your Workshop Trolley is ready for use. **Warning** - *Do not exceed the product's rated maximum load capacity.*

### **3. BEFORE USE**

Prior to each use conduct a visual inspection by checking for abnormal conditions, such as cracked joins and damaged, loose, or missing parts.

### **4. STORAGE**

This Polyethylene Workshop Trolley should always be stored in a dry location on a level surface.

### **5. MAINTENANCE**

Inspect the general condition of the Workshop Trolley checking:

- for loose hardware
- misalignment of binding or parts, cracked, bent, or broken parts, and
- any other condition that may affect the Workshop Trolleys safe operation.
- Clean the Workshop Trolley after each use, ensure, oil, grease and debris are not on the Workshop Trolley.

### **6. SERVICE & REPAIR**

Any Polyethylene Workshop Trolley found damaged in any way, or found to be worn or operates abnormally should be removed from service until repaired by an authorised service agent. Owners and / or operators should be aware that repair of this product may require specialised equipment and knowledge. Only authorised parts, labels and decals shall be used on this equipment. Annual inspection of the Polyethylene Workshop Trolley is recommended and can be made by an authorised repair facility to ensure that your equipment is in optimum condition and that the equipment has the correct decals and safety labels specified by the manufacturer.

## PARTS LIST

Part #	Description	QTY	Part #	Description	QTY
1	Tray	3	8	Castor	4
2	Screw	12	9	Screw	4
3	Handle	1	10	Bracket of Fixed Castor	2
4	Beam	2	11	Nut	16
5	Beam	2	12	Castor	16
6	Bracket of Swivel Castor	2	13	Screw	16
7	Nut	4	14	Rod	1

Please note:  
Handle may vary  
depending on model

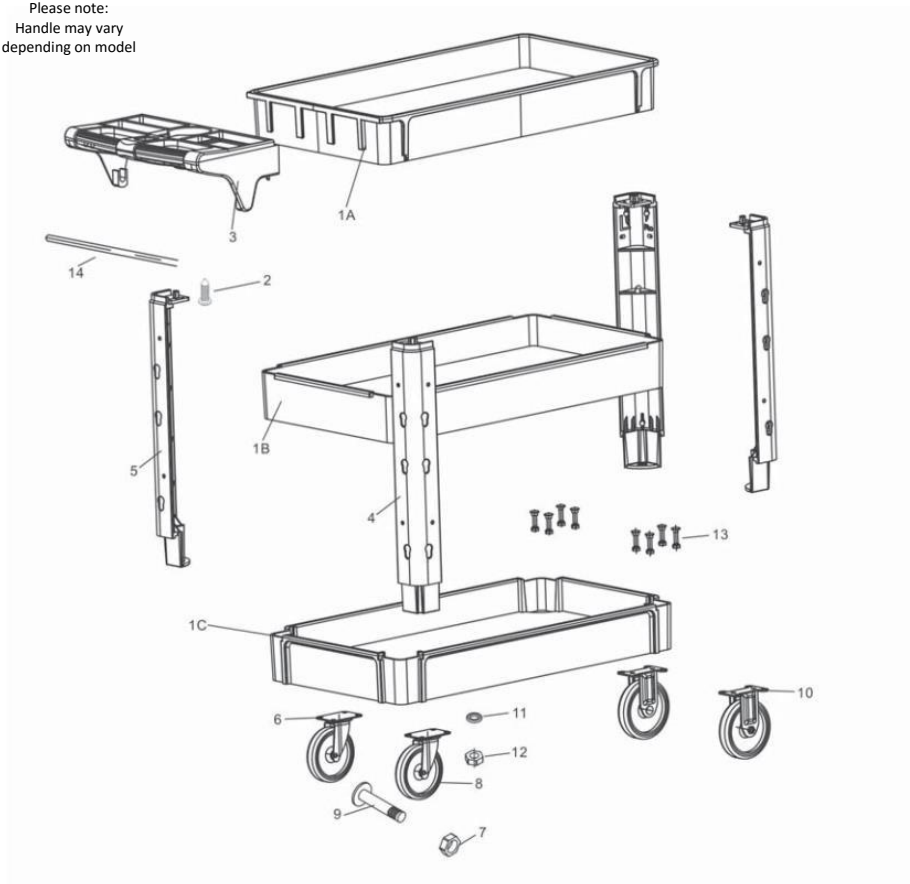

## WARRANTY

Tradequip products have been carefully tested and inspected before shipment and are guaranteed to be free from defective materials and workmanship for a period of 12 months from the date of purchase except where tools are hired out when the guarantee period is ninety days from the date of purchase.

Should this piece of equipment develop any fault, please return the complete tool to your nearest authorised warranty repair agent or contact TQB Brands Pty Ltd Warranty team – [warranty@tqbbrands.com.au](mailto:warranty@tqbbrands.com.au).

If upon inspection it is found that the fault occurring is due to defective materials or workmanship, repairs will be carried out free of charge. This guarantee does not apply to normal wear and tear, nor does it cover any damage caused by misuse, careless or unsafe handling, alterations, accident, or repairs attempted or made by any personnel other than the authorised TQB Brands Pty Ltd repair agent.

This guarantee applies in lieu of any other guarantee expressed or implied and variations of its terms are not authorised.

Your TQB Brands Pty Ltd guarantee is not effective unless you can produce upon request a dated receipt or invoice to verify your proof of purchase within the 12 month period.

### Consumer Guarantee

Our goods come with a guarantee that cannot be excluded under the Australian Consumer Law. You are entitled to a replacement or refund for a major failure and compensation for any other reasonably foreseeable loss or damage. You are also entitled to have the goods repaired or replaced if the goods fail to be of acceptable quality and the failure does not amount to a major failure.