

LineLazer™ Kit for Converting to a High Production (HP) Auto Sprayer

3A3455A

EN

Kit 25A527 for HP Auto upgrade with Laser
Kit 25A932 for HP Auto upgrade without Laser

*For the application of line striping materials.
For professional use only.
Not for use in explosive atmospheres.*



Important Safety Instructions

Read all warnings and instructions in this manual and in related manuals.
Be familiar with the controls and the proper usage of the equipment.
Save these instructions.

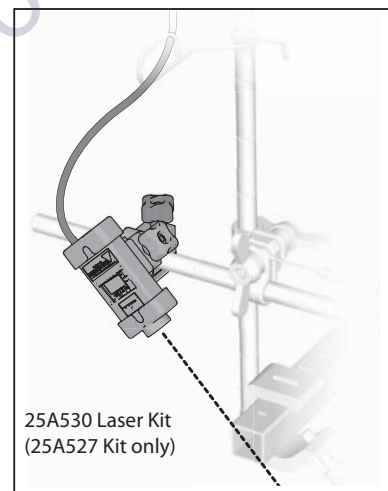
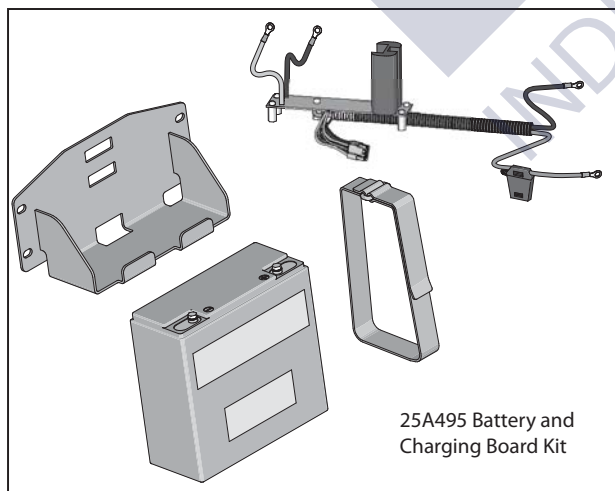
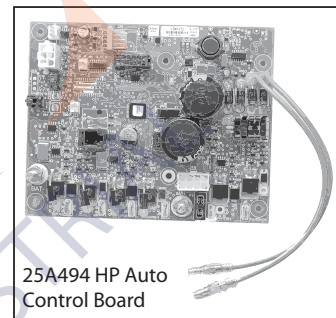
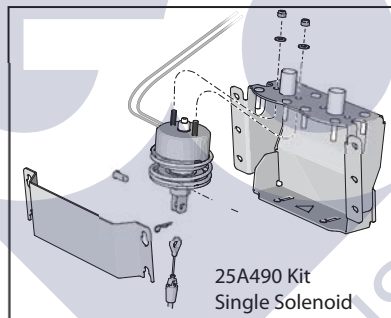
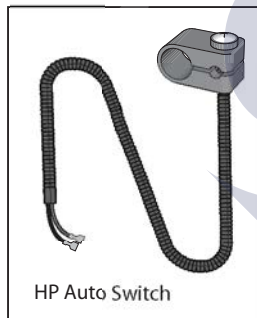

Pressure Relief Procedure

 **WARNING**

SKIN INJECTION HAZARD

This equipment stays pressurized until pressure is manually relieved. To help prevent serious injury from pressurized fluid, such as skin injection, splashing fluid and moving parts, follow the Pressure Relief Procedure when you stop dispensing and before cleaning, checking, or servicing the equipment.

1. Perform **Grounding Procedure** if using flammable materials.

2. Set pump switch to **OFF**. Turn engine **OFF**.
3. Turn pressure control to lowest setting. Trigger all guns to relieve pressure.
4. Engage all gun trigger locks. Turn prime valve down.
5. If you suspect the spray tip or hose is clogged or that pressure has not been fully relieved:
 - a. **VERY SLOWLY** loosen the tip guard retaining nut or the hose end coupling to relieve pressure gradually.
 - b. Loosen the nut or coupling completely.
 - c. Clear the obstruction in the hose or tip.

Installation

1. Remove control cover, disconnect wires, and disconnect old control board.
2. Remove display and display shroud (4 screws).
3. Remove hand grip (spraying compressed air into end of the handle grip works well).
4. Move hand lever forward.
5. Assemble gun control button.
6. Install hand grip.

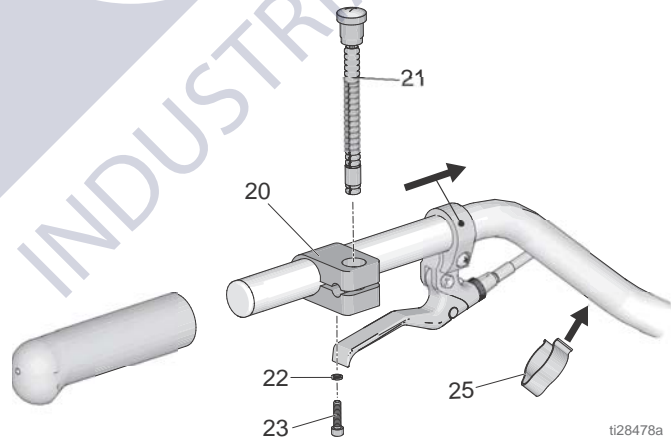
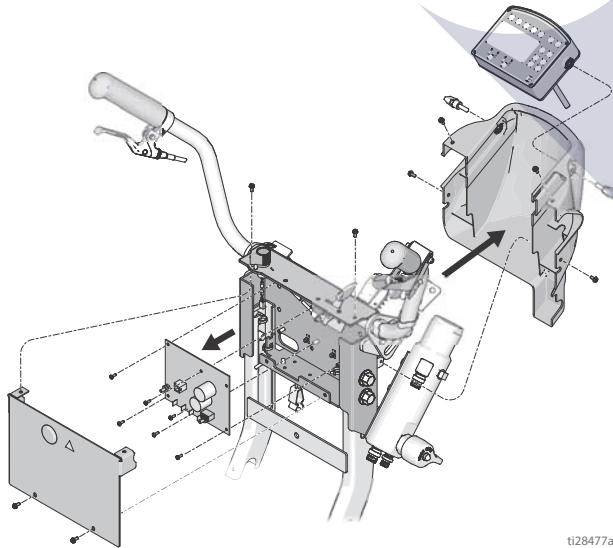

3. Remove hand grip (spraying compressed air into end of the handle grip works well).

7. Insert switch wires (21) into clips (25) and into oval hole.

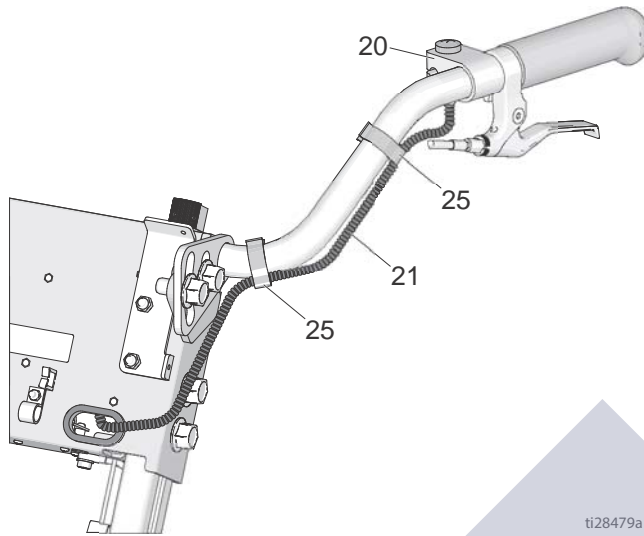

10. Install new battery charging board, Kit 25A495, included in Kit 25A526.

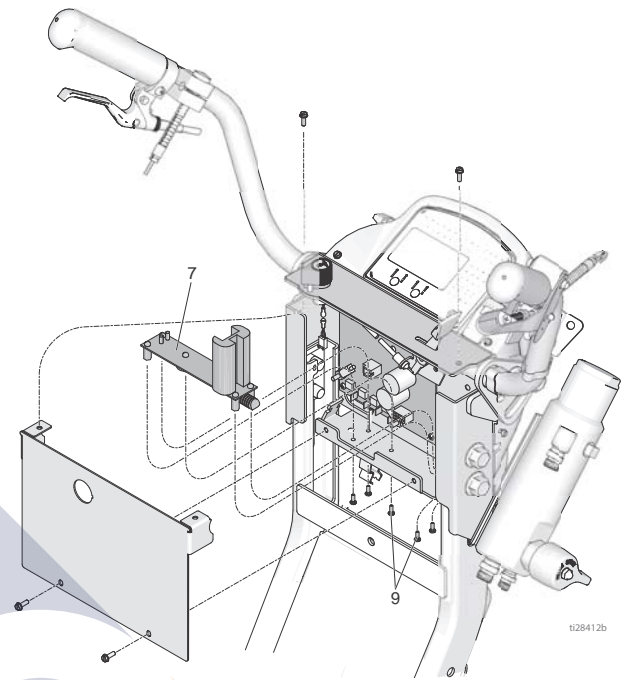

8. Install solenoid bracket, solenoid Kit 25A490, and solenoid cover. Route solenoid wires up through the upright channel to the control box.

NOTICE

Do not allow the solenoid wires to make a sharp bend as shown. Doing so may lead to wire breakage. Place an approximate 0.75" radius bend in the wires exiting the solenoid.

The notice includes a diagram showing a wire being bent. A red circle with a diagonal slash is placed over a sharp 90-degree bend, indicating it is incorrect. Next to it, a diagram shows a wire bent with a smooth, rounded curve, labeled '0.75"', indicating this is the correct method.

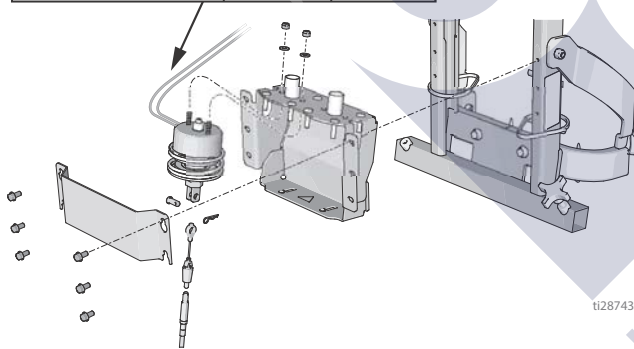

11. Connect short red and black wires on charging board to main board. Loop wires as shown.

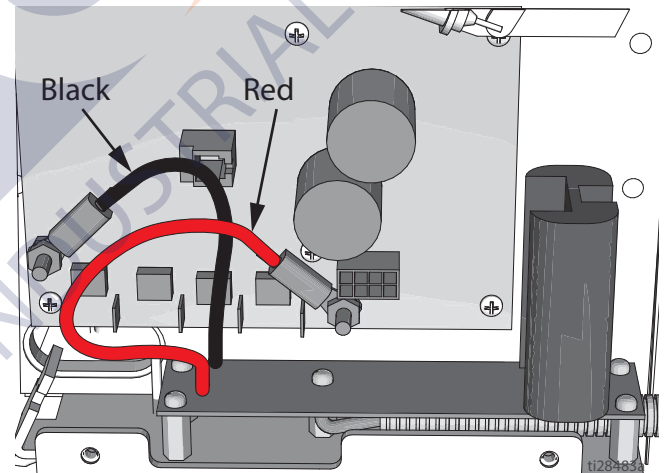

9. Install new main board from Kit 25A494.

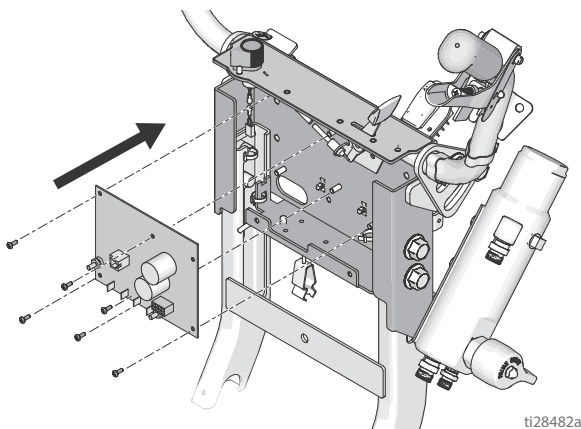

12. For LineLazer V 3900 or 5900, connect the other wires to the main board in the order shown.

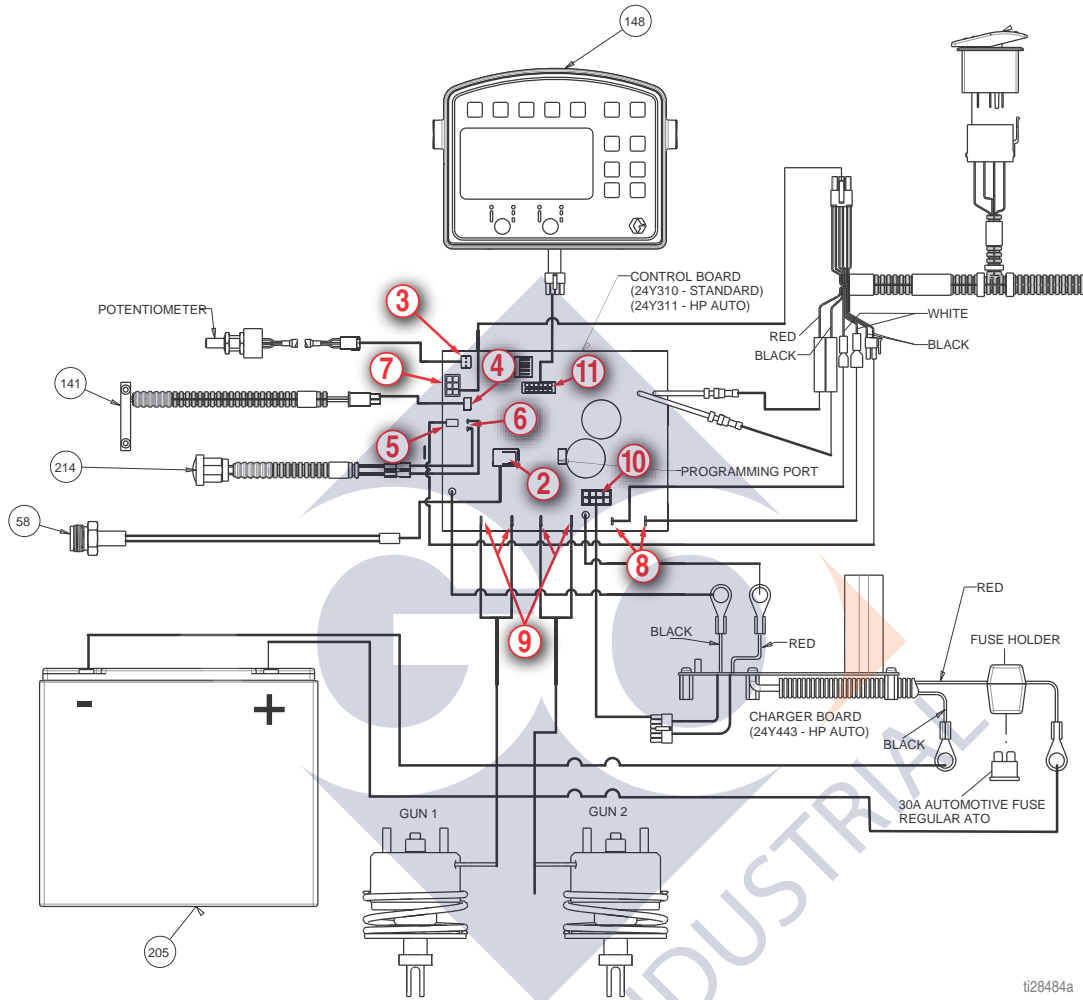

13. For LineLazer V 200HS, connect the other wires to the main board in the order shown.

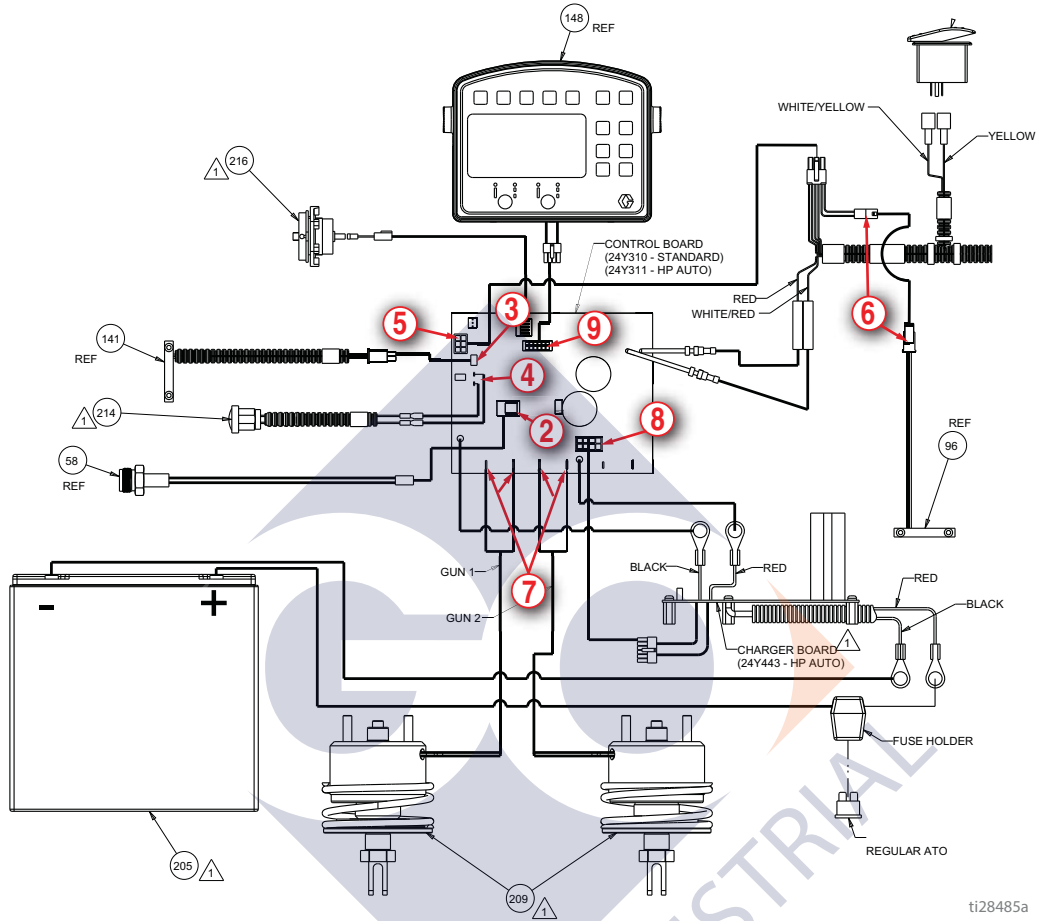

Installation

14. Bundle and cable-tie the two gray wires on the right side of the main board as shown.
15. Do not cable-tie the white solenoid wires.
16. Bundle and cable-tie the wires on the left side of the main board as shown.

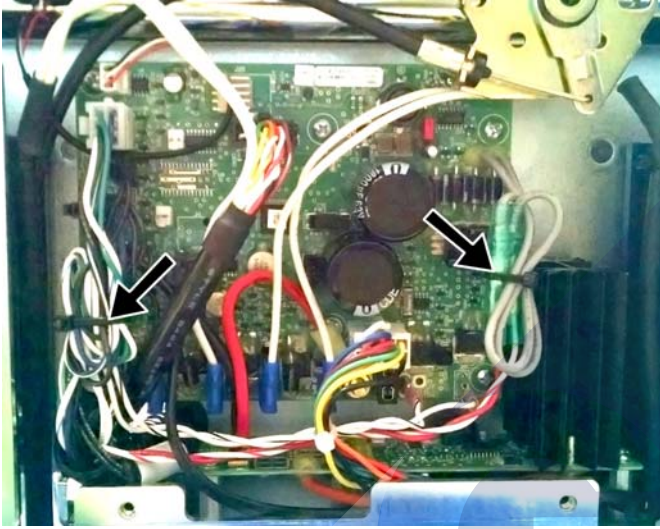

17. Remove battery cover.
18. Install battery bracket, battery, and strap from Kit 25A526.
19. Install Laser Kit 25A530 per Laser Kit Instructions (25A527 Kit with Laser only).

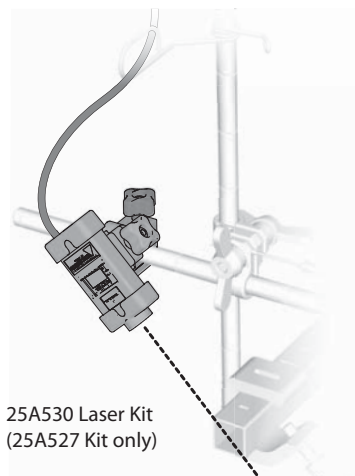

25A530 Laser Kit
(25A527 Kit only)

20. Connect battery leads and install cover.

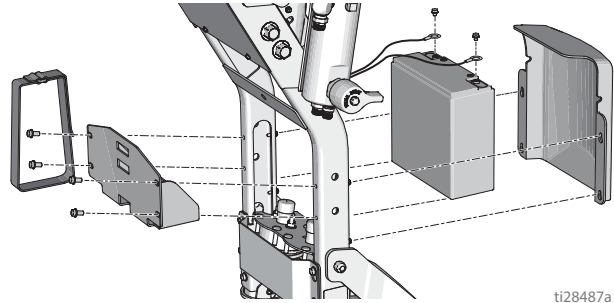

ti28487a

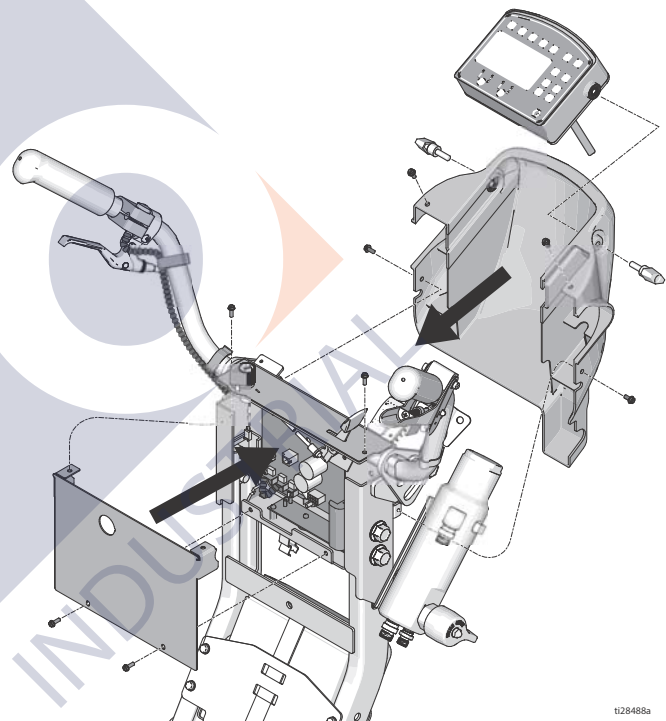

21. Install display shroud and control box cover (do not pinch wires).





ti28488a

- 22. Start engine and calibrate distance sensor per the operation manual (3900, 5900 operation 3A3388; 200HS operation 3A3426).
- 23. After calibration, use the arrows to select the settings screen.

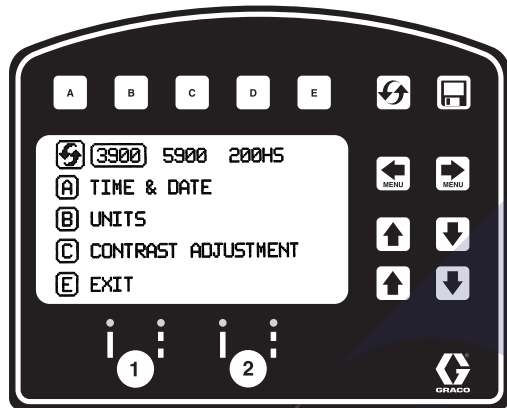

- 24. Select 3900, 5900 or 200HS to match your LineLazer.
- 25. Set time, date, and units to complete the installation.

Use   to select Setup/Information. Press **B** to open Settings Menu.

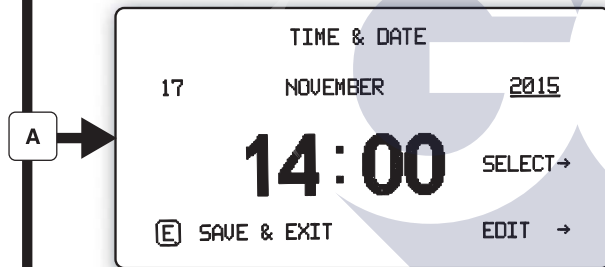

 Chooses the machine type. Necessary for accurate gallon counting.



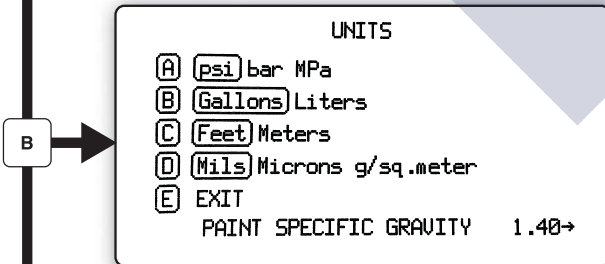

Use   to set time and date.

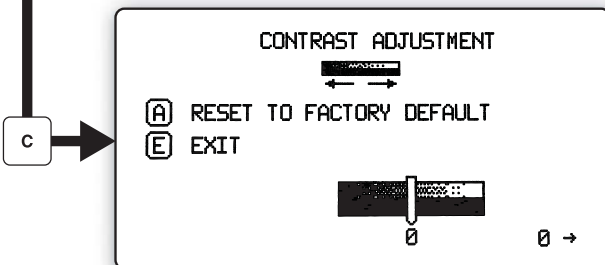

Set units with **A B C D**



Use   to adjust screen contrast to the desired value.

ti27839a



*All written and visual data contained in this document reflects the latest product information available at the time of publication.
Graco reserves the right to make changes at any time without notice.*

Original instructions. This manual contains English. MM 3A3455

Graco Headquarters: Minneapolis

International Offices: Belgium, China, Japan, Korea

GRACO INC. AND SUBSIDIARIES • P.O. BOX 1441 • MINNEAPOLIS MN 55440-1441 • USA
Copyright 2016, Graco Inc. All Graco manufacturing locations are registered to ISO 9001.

www.graco.com

Revision A, April 2016