

Dot Laser Kit and LED Light Kit

3A3478C

EN

Dot Laser Kits:

Kit Number 25A530 for use on LineLazer™ V 3900, 5900 & 200HS HP Automatic Series and 200HS HP Reflective Series

Kit Number 25A691 for use on LineLazer™ 250DC and 250SPS

Kit Number 17P782 for use on LineLazer™ ES1000

Kit Number 17P784 for use on Sure Stripe 3350SP and Brite Striper 3500SP

LED Light Kits:

Kit Number 17R473 for use on LineLazer™ V 3900, 5900 & 200HS HP Automatic Series and 200HS HP Reflective Series

Kit Number 17R472 for use on LineLazer™ ES1000

For installation of the green dot laser and/or LED Light Kit on LineLazer™, Sure Stripe 3350SP, and Brite Striper 3500SP airless line striping systems. For professional use only.



Important Safety Instructions

Read all warnings and instructions in this manual and in related manuals. Be familiar with the controls and the proper usage of the equipment. Save these instructions.

Related Manuals:	
3A3388	LLV 3900/5900 Operation
3A3426	LLV 200HS Operation
3A3393	LLV 250SPS and 250DC Operation
3A4603	LL ES1000 Operation, Repair, Parts
3A4637	SureStripe 3350 Operation, Repair, Parts
3A4555	BriteStriper 3500 Operation
1700-0041	GL1700 Owner's Manual - Operation Guide



LASER LIGHT HAZARD: AVOID DIRECT EYE CONTACT

Eye exposure to Class IIIa/3R levels of laser light can potentially present an eye (retinal) injury hazard, including spot blindness or other retinal injury. Refer to laser warnings in operation manual.

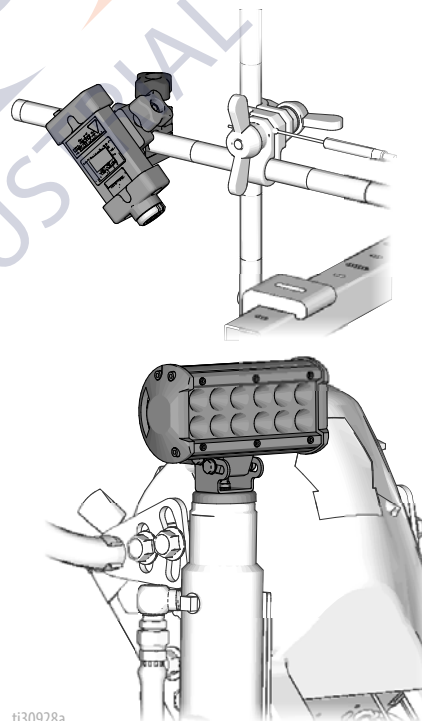

ti30928a



LineLazer V 3900, 5900 & 200HS Models

1. Remove battery cover.

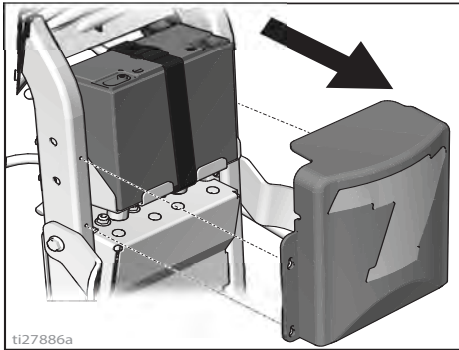

2. Attach ON/OFF switch to desired location on the handle bar.

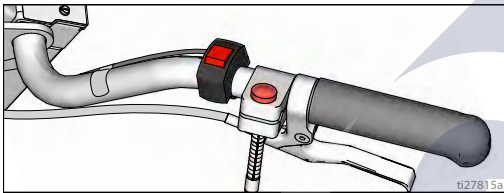

3. Attach laser to desired location on the gun arm.

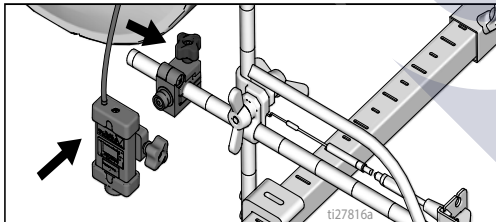

4. Attach light on top of filter cap or on the frame.

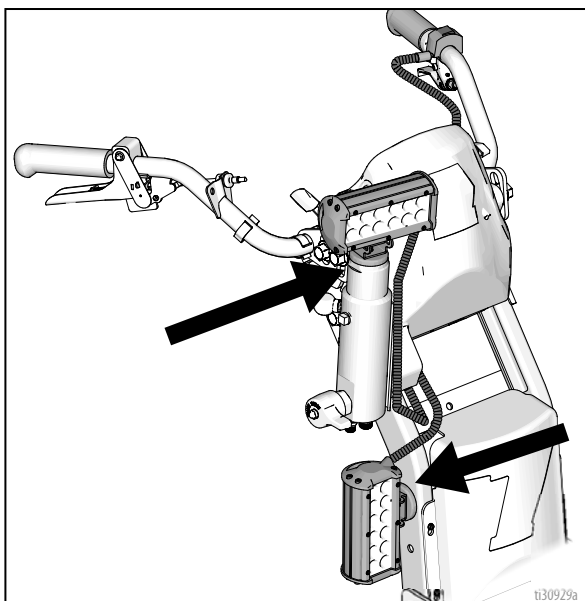

5. Route wires up to the battery and connect to the (+) and (-) terminals.

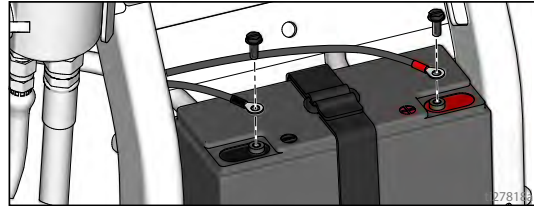

NOTICE

Do not connect GL1700 directly to a generator source as it can create over voltage and damage to the electronics.

6. Connect the switch leads to the laser wire harness.

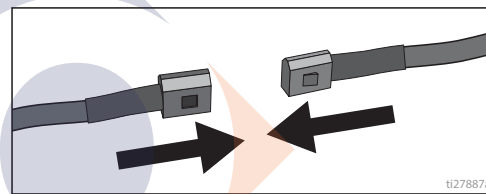

7. Reattach battery cover.

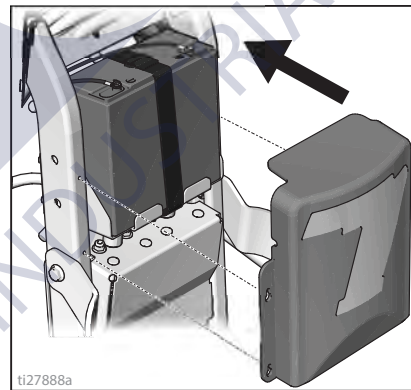

8. Turn on laser and position dot underneath gun head.

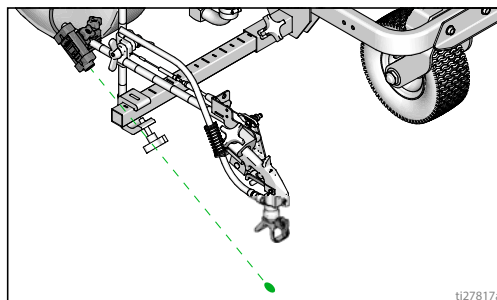

Parts

25A530

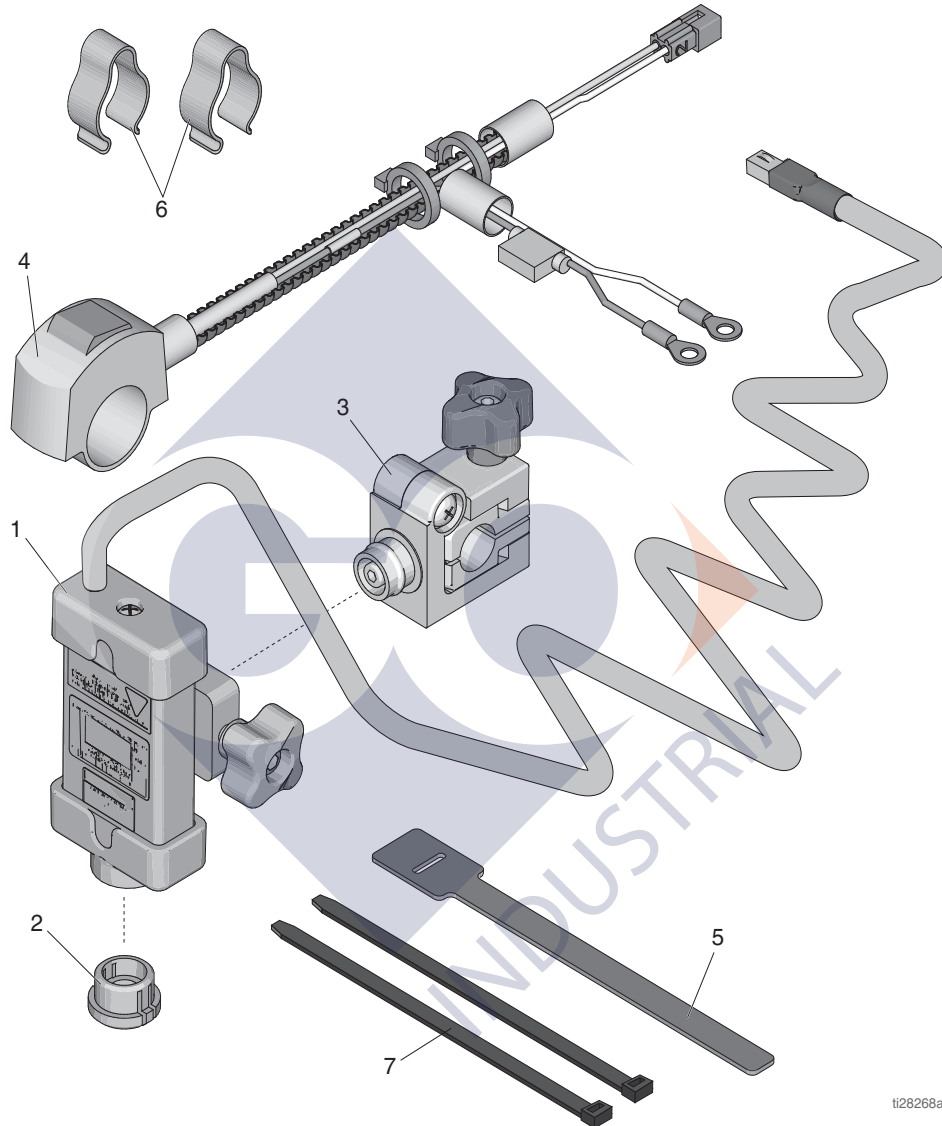

ti28268a

Ref	Part	Description	Qty	Ref	Part	Description	Qty
1	17H714	MODULE, laser, green dot	1	5	128854	STRAP, cable, velcro	1
	128914	MANUAL, operations, laser	1	6	178342	CLIP, spring	2
	128915	CARD, operator, laser	1	7	404989	STRAP, tie	2
	128916	LABEL, operations, laser light	1				
2	128917	SHIELD, paint, laser, assy.	1				
3	128865	BRACKET, mounting, laser, assy.	1				
4	17H713	SWITCH, on/off, laser module	1				
	128857	FUSE, blade, mini, 3 amp	1				

Series A uses an external in-line fuse
Series B uses an internal self-resetting fuse
Series C uses an internal self-resetting fuse and an external in-line fuse

LineLazer 250SPS & 250DC

1. Lower platform.

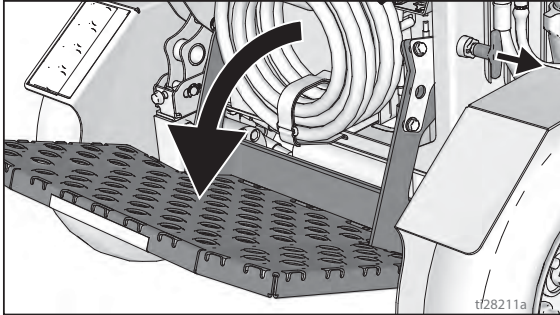

2. Remove coiled hose.

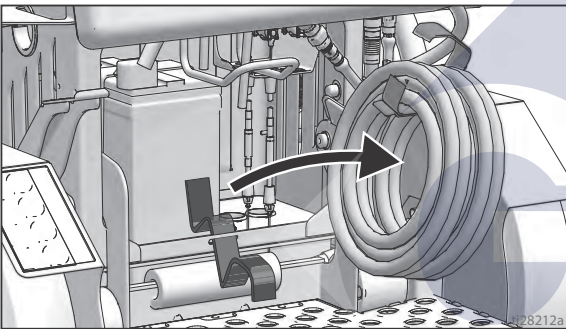

3. Remove battery.

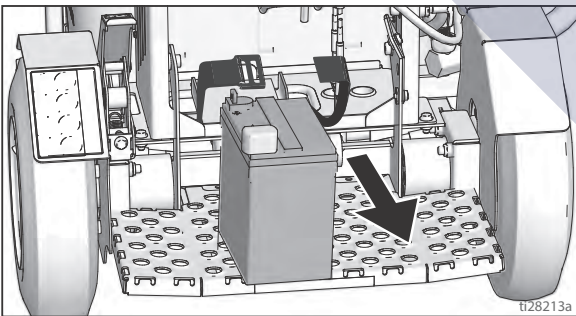

4. Attach ON/OFF switch on right side of handlebar and connect jumper.

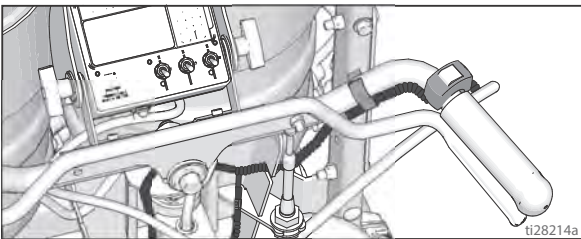

5. Route switch wiring between piston and square tube, and down to battery.

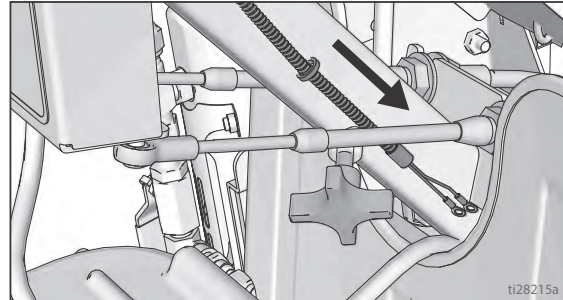

6. Route jumper between piston and square tube, and down to gun cable hole.

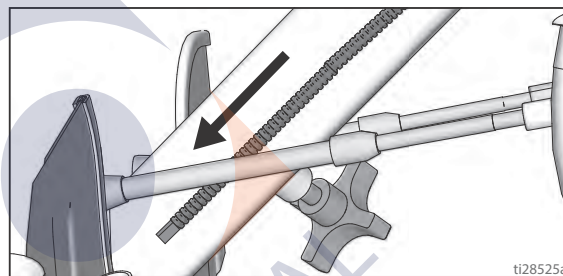

7. Secure switch wiring and jumper using cable tie.

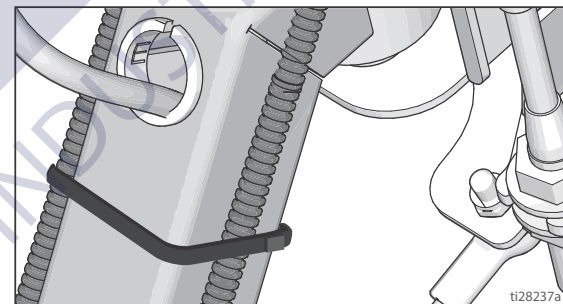

8. Attached laser to desired location on gun arm.

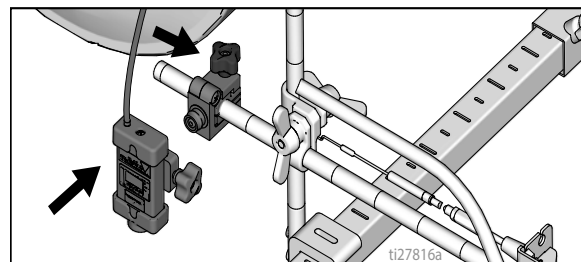

9. Attach light on top of filter cap or on the frame.

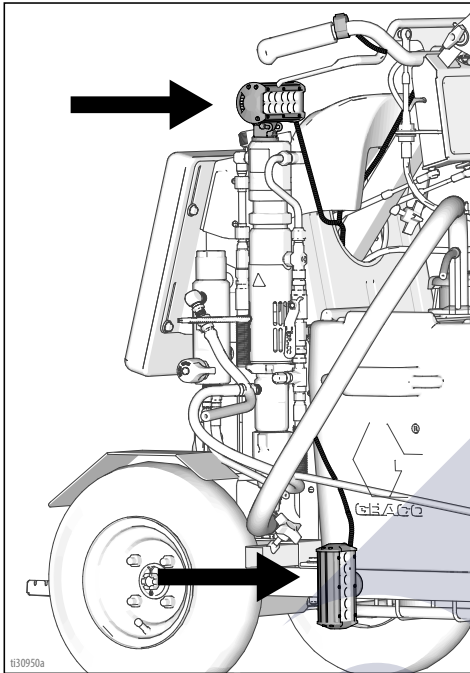

11. Connect the jumper to the laser wire harness, and secure all cables as necessary.

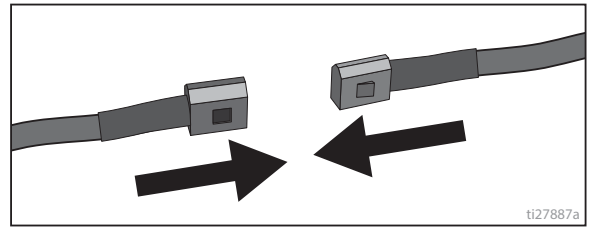

12. Reinstall the battery.

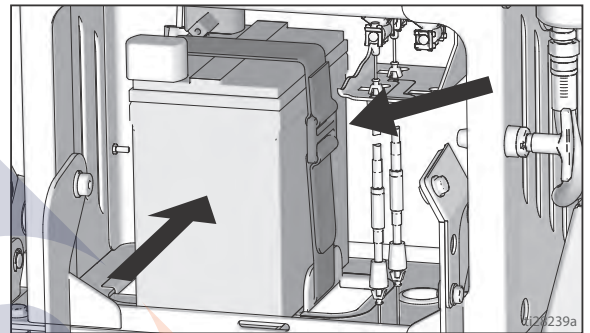

10. Route switch wires down to battery and connect to the (+) and (-) terminals, and route jumper through gun cable hole.

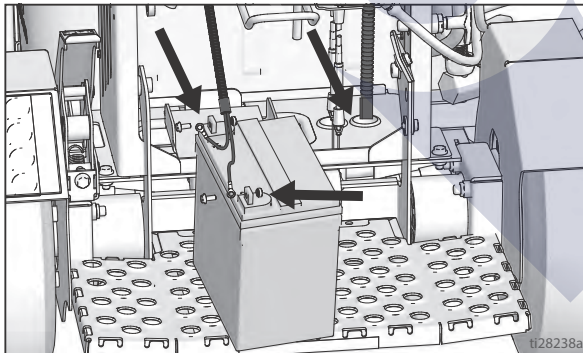

13. Replace the coiled hose.

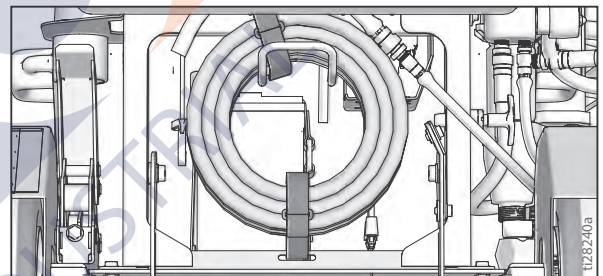

14. Turn on laser and position dot underneath gun head.

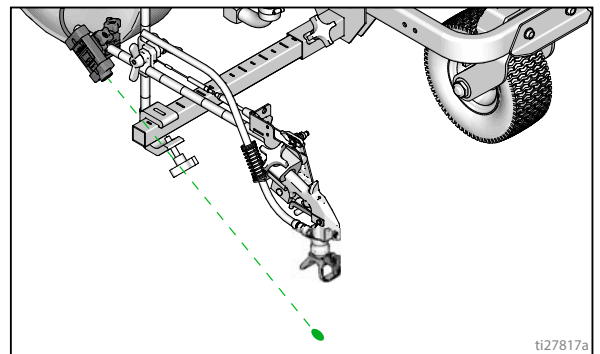

NOTICE

Do not connect GL1700 directly to a generator source as it can create over voltage and damage to the electronics.

Parts

25A691

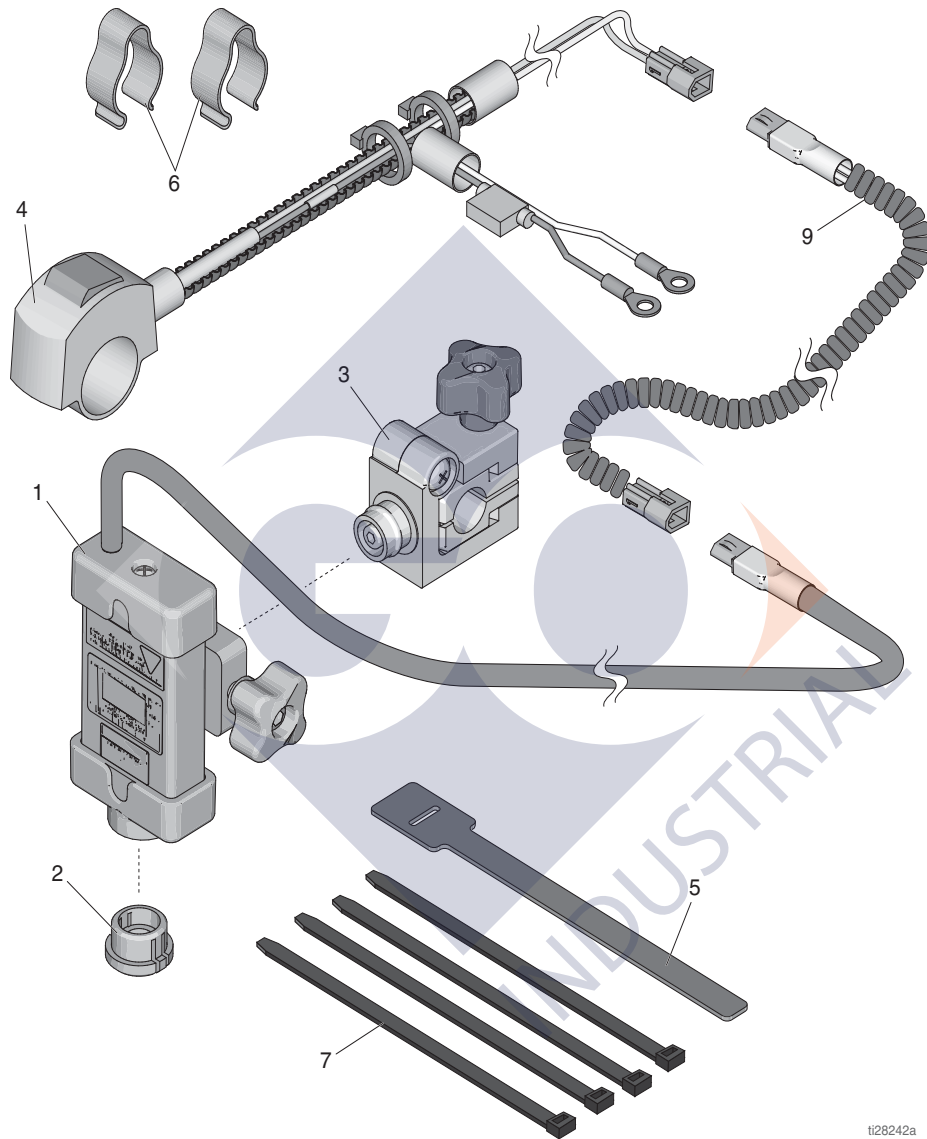

ti26242a

Ref	Part	Description	Qty	Ref	Part	Description	Qty
1	17H714	MODULE, laser, green dot	1	5	128854	STRAP, cable, velcro	1
	128914	MANUAL, operations, laser	1	6	178342	CLIP, spring	2
	128915	CARD, operator, laser	1	7	404989	TIE, strap	4
	128916	LABEL, operations, laser light	1	9	17H745	CONDUCTOR, electrical, jumper	1
2	128917	SHIELD, paint, laser, assy.	1				
3	128865	BRACKET, mounting, laser, assy.	1				
4	17H718	SWITCH, on/off, laser module	1				
	128857	FUSE, blade, mini, 3 amp	1				

Series A uses an external in-line fuse
Series B uses an internal self-resetting fuse
Series C uses an internal self-resetting fuse and an external in-line fuse

Parts

17P782

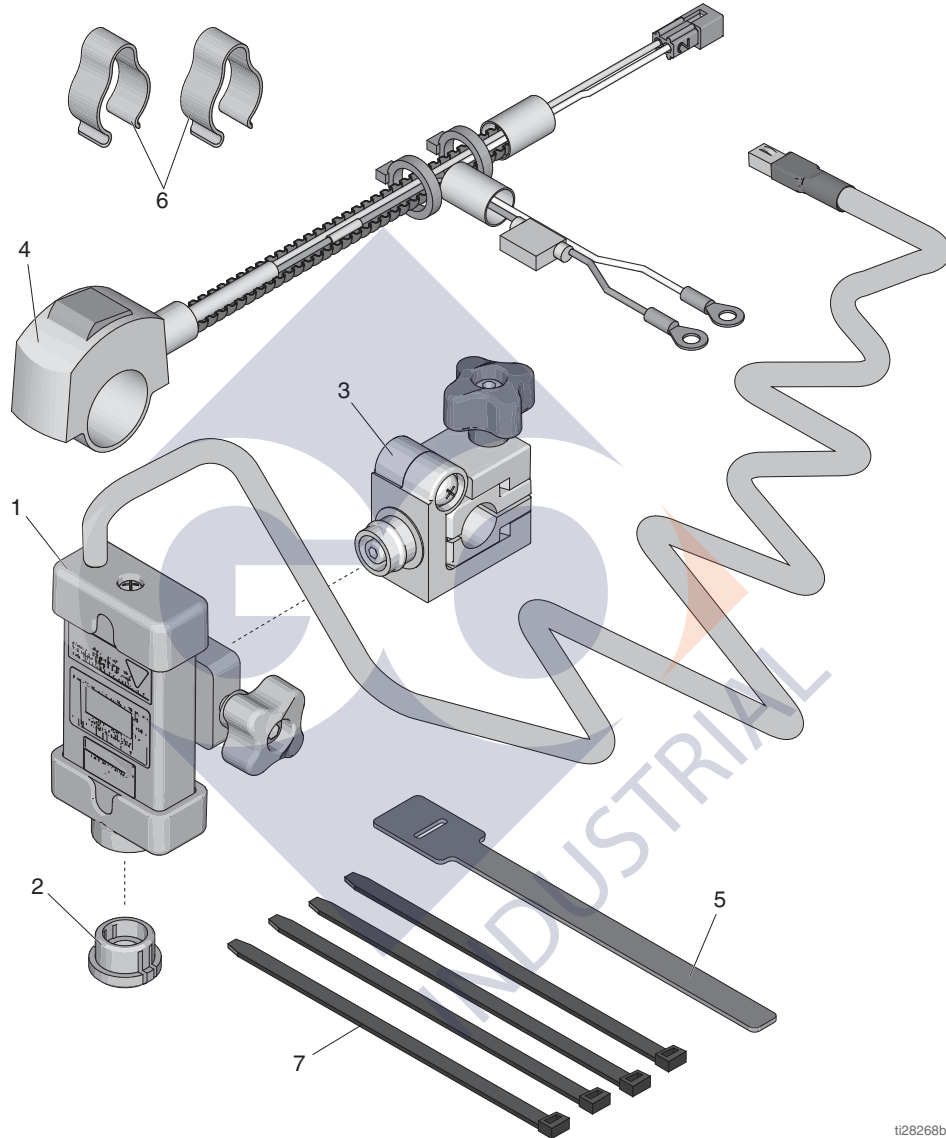

ti28268b

Ref	Part	Description	Qty	Ref	Part	Description	Qty
1	17H714	MODULE, laser, green dot	1	5	128854	STRAP, cable, velcro	1
	128914	MANUAL, operations, laser	1	6	178342	CLIP, spring	2
	128915	CARD, operator, laser	1	7	404989	STRAP, tie	4
	128916	LABEL, operations, laser light	1				
2	128917	SHIELD, paint, laser, assy.	1			<i>Series A uses an external in-line fuse</i>	
3	128865	BRACKET, mounting, laser, assy.	1			<i>Series B uses an internal self-resetting fuse</i>	
4	17P947	SWITCH, on/off, laser module	1			<i>Series C uses an internal self-resetting fuse and an external in-line fuse</i>	
	128857	FUSE, blade, mini, 3 amp	1				

Parts

17P784

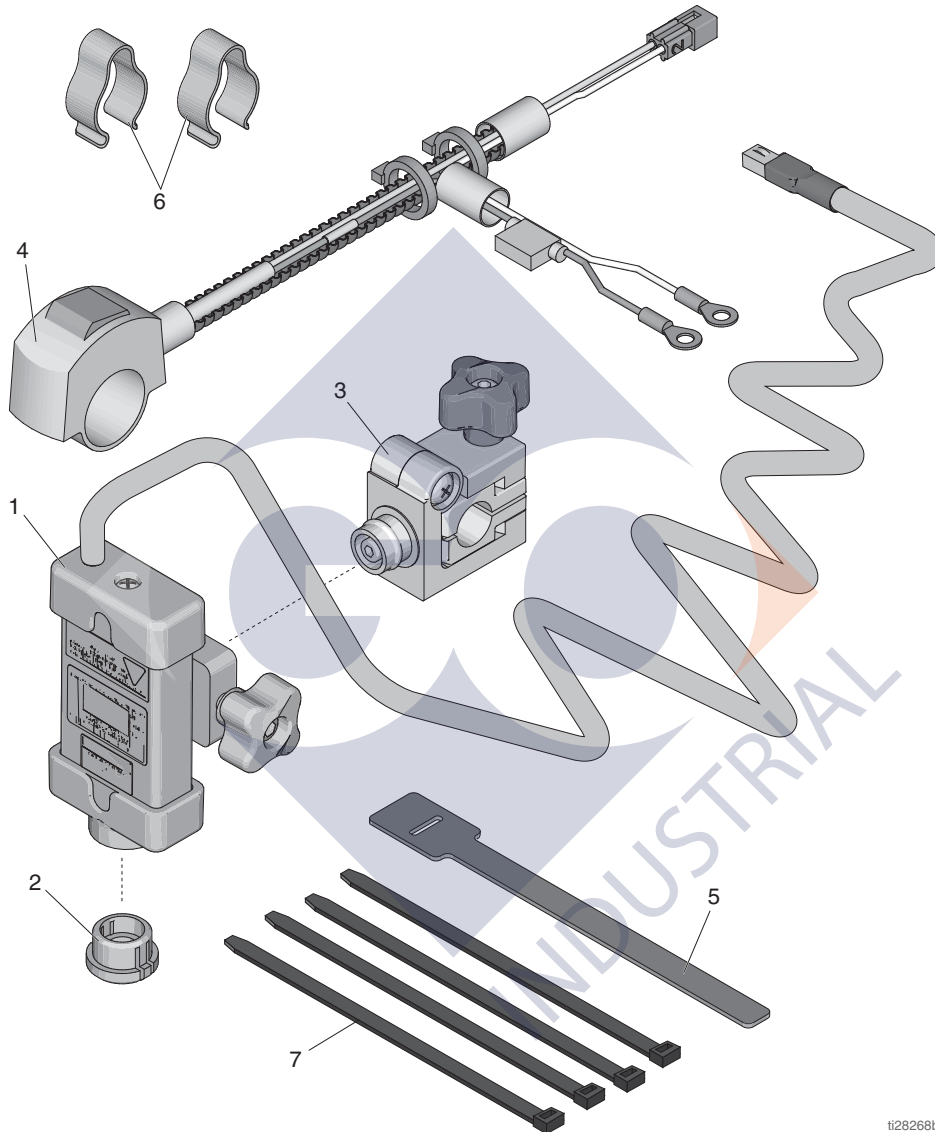

ti28268b

Ref	Part	Description	Qty	Ref	Part	Description	Qty
1	17H714	MODULE, laser, green dot	1	5	128854	STRAP, cable, velcro	1
	128914	MANUAL, operations, laser	1	6	178342	CLIP, spring	2
	128915	CARD, operator, laser	1	7	404989	STRAP, tie	4
	128916	LABEL, operations, laser light	1				
2	128917	SHIELD, paint, laser, assy.	1			<i>Series A uses an external in-line fuse</i>	
3	128865	BRACKET, mounting, laser, assy.	1			<i>Series B uses an internal self-resetting fuse</i>	
4	17P494	SWITCH, on/off, laser module	1			<i>Series C uses an internal self-resetting fuse and an external in-line fuse</i>	
	128857	FUSE, blade, mini, 3 amp	1				

Parts

17R472 and 17R473

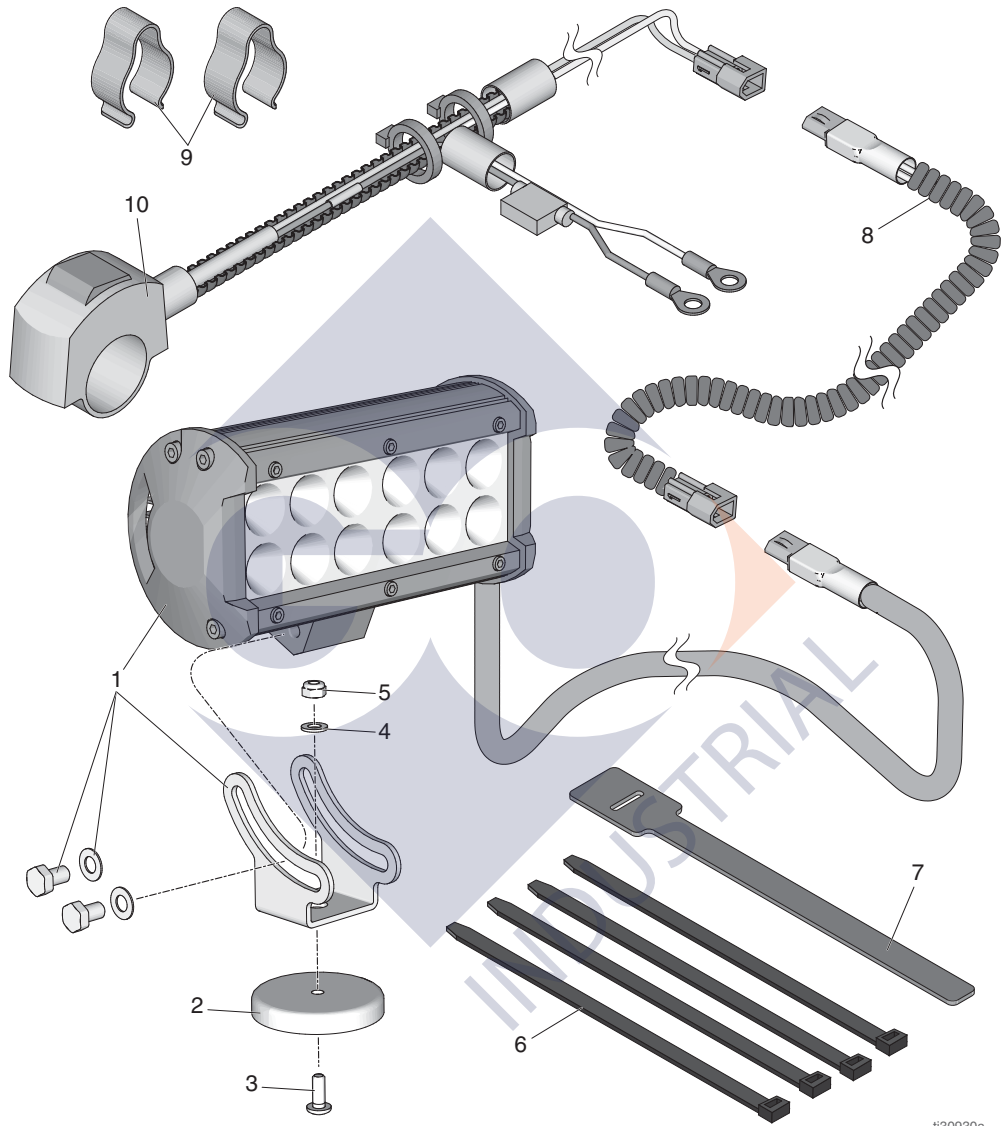

ti30930a

Ref	Part	Description	Qty	Ref	Part	Description	Qty
1*	17R459	LIGHT	1	8*	17H745	CONDUCTOR	1
2*	17R460	MAGNET	1	9*	178342	CLIP	2
3*	116610	SCREW	1	10	17P947	SWITCH (used on 17R472 only)	1
4*	116876	WASHER	1		17H713	SWITCH (used on 17R473 only)	1
5*	115483	NUT	1				
6*	404989	STRAP, tie	4				
7*	128854	STRAP, velcro	1				

* Kit 17R458 includes items 1-9

Graco Standard Warranty

Graco warrants all equipment referenced in this document which is manufactured by Graco and bearing its name to be free from defects in material and workmanship on the date of sale to the original purchaser for use. With the exception of any special, extended, or limited warranty published by Graco, Graco will, for a period of twelve months from the date of sale, repair or replace any part of the equipment determined by Graco to be defective. This warranty applies only when the equipment is installed, operated and maintained in accordance with Graco's written recommendations.

This warranty does not cover, and Graco shall not be liable for general wear and tear, or any malfunction, damage or wear caused by faulty installation, misapplication, abrasion, corrosion, inadequate or improper maintenance, negligence, accident, tampering, or substitution of non-Graco component parts. Nor shall Graco be liable for malfunction, damage or wear caused by the incompatibility of Graco equipment with structures, accessories, equipment or materials not supplied by Graco, or the improper design, manufacture, installation, operation or maintenance of structures, accessories, equipment or materials not supplied by Graco.

This warranty is conditioned upon the prepaid return of the equipment claimed to be defective to an authorized Graco distributor for verification of the claimed defect. If the claimed defect is verified, Graco will repair or replace free of charge any defective parts. The equipment will be returned to the original purchaser transportation prepaid. If inspection of the equipment does not disclose any defect in material or workmanship, repairs will be made at a reasonable charge, which charges may include the costs of parts, labor, and transportation.

THIS WARRANTY IS EXCLUSIVE, AND IS IN LIEU OF ANY OTHER WARRANTIES, EXPRESS OR IMPLIED, INCLUDING BUT NOT LIMITED TO WARRANTY OF MERCHANTABILITY OR WARRANTY OF FITNESS FOR A PARTICULAR PURPOSE.

Graco's sole obligation and buyer's sole remedy for any breach of warranty shall be as set forth above. The buyer agrees that no other remedy (including, but not limited to, incidental or consequential damages for lost profits, lost sales, injury to person or property, or any other incidental or consequential loss) shall be available. Any action for breach of warranty must be brought within two (2) years of the date of sale.

GRACO MAKES NO WARRANTY, AND DISCLAIMS ALL IMPLIED WARRANTIES OF MERCHANTABILITY AND FITNESS FOR A PARTICULAR PURPOSE, IN CONNECTION WITH ACCESSORIES, EQUIPMENT, MATERIALS OR COMPONENTS SOLD BUT NOT MANUFACTURED BY GRACO. These items sold, but not manufactured by Graco (such as electric motors, switches, hose, etc.), are subject to the warranty, if any, of their manufacturer. Graco will provide purchaser with reasonable assistance in making any claim for breach of these warranties.

In no event will Graco be liable for indirect, incidental, special or consequential damages resulting from Graco supplying equipment hereunder, or the furnishing, performance, or use of any products or other goods sold hereto, whether due to a breach of contract, breach of warranty, the negligence of Graco, or otherwise.

Graco Information

For the latest information about Graco products, visit www.graco.com.

For patent information, see www.graco.com/patents.

TO PLACE AN ORDER, contact your Graco distributor or call 1-800-690-2894 to identify the nearest distributor.

All written and visual data contained in this document reflects the latest product information available at the time of publication. Graco reserves the right to make changes at any time without notice.

Original instructions. This manual contains English. MM 3A3478

Graco Headquarters: Minneapolis

International Offices: Belgium, China, Japan, Korea

GRACO INC. AND SUBSIDIARIES • P.O. BOX 1441 • MINNEAPOLIS MN 55440-1441 • USA
Copyright 2016, Graco Inc. All Graco manufacturing locations are registered to ISO 9001.

www.graco.com

Revision C, February 2017