

Instructions



Harrier[®] EZ Chemical Injection Controller

3A4700E
EN

For controlling and monitoring an automated injection system. Not approved for outdoor use. For professional use only.

Not approved for use in explosive atmospheres or hazardous locations.

B32110

See page 2 for approvals.



Important Safety Instructions

Read all warnings and instructions in this manual.
Save these instructions.



ti30256b



Table of Contents

| | | | |
|---|----------|--------------------------------------|-----------|
| Approvals | 2 | Troubleshooting | 9 |
| Related Manuals | 2 | Accessories | 9 |
| Warnings | 3 | Related Kits | 9 |
| Component Identification | 4 | Dimensions | 10 |
| Keypad, Display, and Icons | 4 | Technical Data | 11 |
| Installation | 5 | Graco Standard Warranty | 12 |
| Typical Installation and Wiring Diagram | 5 | Graco Information | 12 |
| Installing the Injection Controller | 6 | | |
| Operation | 7 | | |
| Low-Voltage Disconnect | 7 | | |
| High Temperature Mode | 7 | | |
| Cool Down Mode | 7 | | |
| Setup Modes | 7 | | |
| Prime Mode | 8 | | |
| Sleep Mode | 8 | | |
| Alarm Operation | 8 | | |

Approvals



Intertek
3151640
Certified to CAN/CSA C22.2 No. 14
Conforms to
UL 508





Related Manuals

| Manual No. | Description |
|------------|---|
| 334913 | Wolverine Basic Chemical Injection System |
| 334513 | Wolverine Chemical Injection Pump |
| 3A5028 | G-Chem Chemical Injection Pump |

Warnings

The following warnings are for the setup, use, grounding, maintenance, and repair of this equipment. The exclamation point symbol alerts you to a general warning and the hazard symbols refer to Procedure-specific risks. When these symbols appear in the body of this manual or on warning labels, refer back to these Warnings. Product-specific hazard symbols and warnings not covered in this section may appear throughout the body of this manual where applicable.

|  <h1 style="margin: 0;">WARNING</h1> | |
|---|--|
|  | <p>EQUIPMENT MISUSE HAZARD</p> <p>Misuse can cause death or serious injury.</p> <ul style="list-style-type: none"> • Do not operate the unit when fatigued or under the influence of drugs or alcohol. • Do not exceed the maximum working pressure or temperature rating of the lowest rated system component. See Technical Data in all equipment manuals. • Use fluids and solvents that are compatible with equipment wetted parts. See Technical Data in all equipment manuals. Read fluid and solvent manufacturer's warnings. For complete information about your material, request Safety Data Sheet (SDS) from distributor or retailer. • Turn off all equipment when not in use and follow the Pressure Relief Procedure when equipment is not in use. • Check equipment regularly. Repair or replace worn or damaged parts immediately with genuine manufacturer's replacement parts only. • Do not alter or modify equipment. Alterations or modifications may void agency approvals and create safety hazards. • Make sure all equipment is rated and approved for the environment in which you are using it. • Use equipment only for its intended purpose. Call your distributor for information. • Route hoses and cables away from traffic areas, sharp edges, moving parts, and hot surfaces. • Keep children and animals away from work area. • Comply with all applicable safety regulations. |

Component Identification

Keypad, Display, and Icons

NOTICE
To prevent damage to soft key buttons, do not press the buttons with sharp objects such as pens, plastic cards, or fingernails.

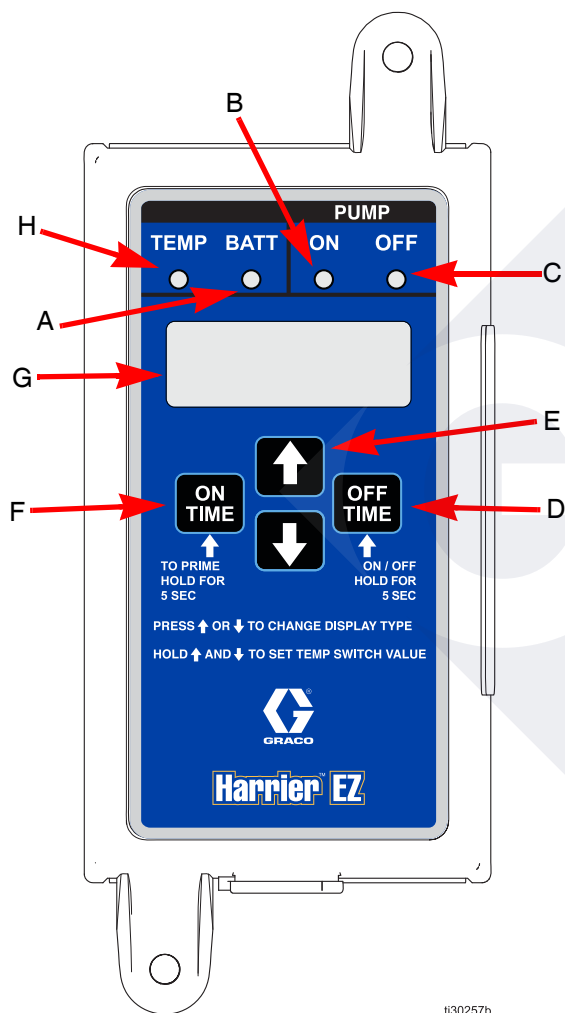

FIG. 1

BATT LED (A)

- Indicates when the voltage is being displayed. Blinks when in Low Voltage Disconnected mode.

PUMP LEDs (B & C)

- ON LED (B): In Run Mode, this LED is lit during the On portion of the Run cycle.
- OFF LED (C): In Run Mode, this LED is lit during the Off portion of the Run cycle.

TEMP LED (H)

- Indicates when temperature is being displayed. Blinks when in High Temperature Mode.

OFF TIME (D)

- In Setup Mode, saves entry.
- Toggles controller between Run Mode and Off Time Setup Mode.
- Press and hold for five seconds to enter Sleep Mode.

Up and Down Direction Arrows (E)

- In Setup Mode, increase or decrease the time.
- In Run Mode, toggle between two display types: pump on/off countdown and battery voltage.
- Press both Direction Arrows at the same time for three seconds to enter Temperature Setpoint Mode.

ON TIME / Prime Mode (F)

- In Setup Mode, saves entry.
- Toggles controller between Run Mode and On Time Setup Mode.
- Press and hold for five seconds to start Prime Mode.

Display (G)

- In Run Mode, press the Up and Down Arrows (E) to toggle between three display types: Pump On/Off Countdown, Battery Voltage, and Temperature.
- When a Pump LED (B or C) is lit, a 4-digit countdown display counts down the remaining seconds in the corresponding On or Off portion of the Run cycle. The possible range is 0-9999 seconds.
- When the BATT LED (A) is lit, the 3-digit battery display shows the current battery charge in 0.1 V intervals. The pump still cycles on and off while the battery voltage is displayed.
- When the TEMP LED (H) is lit, temperature is displayed to the nearest degree Fahrenheit.

Installation

Typical Installation and Wiring Diagram

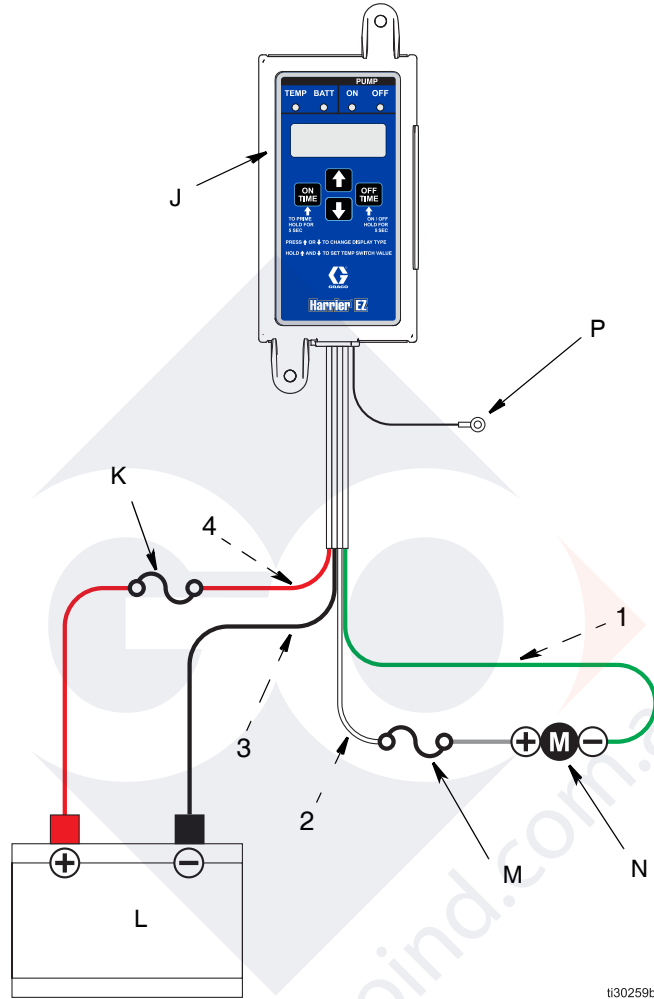

FIG. 2 Typical Installation and Wiring

FIG. 2 is an example of a Harrier EZ chemical injection controller installation. Your installation may differ from what is shown here. The controller (J), with wiring, is supplied by Graco. All other components are supplied by the customer. Contact your Graco distributor for assistance in planning a system to suit your needs.

Key:

- J Controller
- K In-line Fuse (battery) - UL 248 approved, 15A or 20A max (per motor size)
- L Battery (12 V or 24 V)
- M In-line Fuse (pump) - UL 248 approved, 15A or 20A max (per motor size)
- N Pump
- P Thermistor Lug

Wiring Key:

- 1 Pump (-), green
- 2 Pump (+), white
- 3 Ground (-), black
- 4 Voltage Input (+), red

Installing the Injection Controller



AUTOMATIC SYSTEM ACTIVATION HAZARD





Unexpected activation of the system could result in serious injury, including skin injection and amputation.

This device has an automatic timer that activates the pump injection system when power is connected or when exiting the programming function. Before you install or remove the Injection Controller from the system, disconnect and isolate all power supplies.

1. Select a flat surface to install the Injection Controller. Drill mounting holes. Refer to **Dimensions** on page 10.
2. Align junction box with predrilled holes. Use two screws (not provided) to secure junction box to mounting surface.

goind.com.au

Operation

| | | | | |
|---|---|---|---|--|
|  |  |  |  | |
| <p>AUTOMATIC SYSTEM ACTIVATION HAZARD</p> <p>Unexpected activation of the system could result in serious injury, including skin injection and amputation.</p> <p>This device has an automatic timer that activates the pump injection system when power is connected or when exiting the programming function. Before you install, service, or remove the pump from the system, pull the motor fuse (see pump manual) and disconnect and isolate all power supplies.</p> | | | | |

Low-Voltage Disconnect

The Low-Voltage Disconnect (LVD) is a non-settable feature that stops the pump from running to protect the batteries from extreme discharge. Auto-detection exists for 12 V and 24 V systems.

The following table summarizes the low-voltage thresholds for disconnection after five seconds and charges required for reconnection.

| Input Power | LVD | |
|-------------|-----------------------|----------------------------------|
| | five-second threshold | Charge required for reconnection |
| 12 V | 11 V | 12 V |
| 24 V | 22 V | 24 V |

Whenever the battery voltage drops below the specified threshold, the BATT LED (A) flashes, “LVD” appears in the display (G), and the pump stops. (See **Keypad, Display, and Icons** on page 4.)

The controller automatically resumes Run Mode once the battery recharges to the level required for reconnection.

High Temperature Mode

When the temperature is greater than the temperature setpoint, the controller will be in High Temperature Mode and the display will read “Hi T”. The pump will remain off until the temperature cools below 2° of the setpoint. Then, the controller will switch to Run Mode.

Cool Down Mode

When the controller detects that it is too hot, it will turn the pump off and display “HOT”. Once it has cooled down, the controller will automatically resume running.

Setup Modes

1. While in Run Mode (either of the ON or OFF LEDs are lit and not blinking), press the ON TIME button (F) to enter On Time Setup Mode (the ON or OFF LED is blinking). (See **Keypad, Display, and Icons** on page 4.) To exit Setup modes, press the ON Time button or OFF Time button.
2. Press and hold the Up or Down arrow buttons (E) to increase or decrease the duration of On Time in seconds. (The rate of increase or decrease increases the longer an arrow button is held.) To exit Temp Setup Mode, press and hold the Up and Down arrow buttons (E).
3. Press the ON TIME button (F) again once the desired On Time setpoint is displayed. “SAVE” will appear in the display (G) and the controller will return to Run Mode.
4. Repeat steps 1-3 using the OFF TIME button (D) to enter Off Time Setup Mode and to set the Off Time Setpoint.
5. While in Run Mode, press the Up and Down buttons at the same time for three seconds to enter the Temperature Setpoint Mode. The pump only functions between -40°F and 131°F (-40 °C and 55 °C).

Prime Mode

While in Run Mode (either of the ON or OFF LEDs are lit and not blinking), press and hold the ON TIME button (F) for five seconds to enter Prime Mode. This will turn the pump on for 30 seconds, which appear on the display (G) as it counts down to “0”. (See **Keypad, Display, and Icons** on page 4.)

Once the countdown is complete, the pump will return to Run Mode and continue its cycle of Off and On according to the setpoints entered in the On Time and Off Time Setup Modes.

NOTE: The Prime Mode countdown can be canceled at any time by pressing any button. The pump will return to Run Mode and normal operation.

Sleep Mode

While in Run Mode (either of the ON or OFF LEDs (B or C) are lit and not blinking), press and hold the OFF TIME button (D) for five seconds to put the controller in Sleep Mode. To wake the controller, press and hold the OFF TIME button (D) for five seconds. The controller will then resume Run Mode.

Alarm Operation

When an alarm situation occurs:

- pump operation is disabled,
- an error code displays.

Cycle power to clear alarm.

NOTE: Alarms are visual only.

| Alarm Type | Error Code | Description | Things to Check/Do |
|-------------|------------|--|---|
| Memory | Er:EE | Problem writing setup values to memory | Cycle power. Try writing values again. If error persists, contact Graco Customer Support. |
| Low Voltage | Er:LV | Voltage too low to safely write memory | Cycle power. Allow battery to charge up before trying to write values again. If error persists, contact Graco Customer Support. |

Troubleshooting

| Description | Problem | Solution |
|---|------------------------------------|---|
| Unit does not power on or display is dim/unresponsive | Incorrect or loose wiring | Refer to installation instructions beginning on page 5. |
| | Input voltage is out of range | Confirm power source is between 9 and 26 VDC. |
| | Blown external fuse | Confirm that none of the devices or wiring connected to the controller are causing a short circuit connection. Replace fuse. If fuse trips again, contact Graco Customer Support. |
| Motor is stuck in the On portion of the Run cycle. | Incorrect wiring | Verify the wiring on page 5. If the pump remains stuck in the On portion of the Run cycle, contact Graco Customer Support. |
| Controller flashes software revision code (i.e. 1.14) | Low voltage supplied to controller | Remove motor fuse and verify controller operation. If controller operates without motor fuse, charge or replace battery. If controller does not operate properly without motor fuse, contact Graco Customer Support |

Accessories

Related Kits

| Kit No. | Description |
|---------------|----------------|
| B32070 | 15A Fuses (10) |
| B32071 | 20A Fuses (10) |

Dimensions

NOTE: The following image is not to scale.

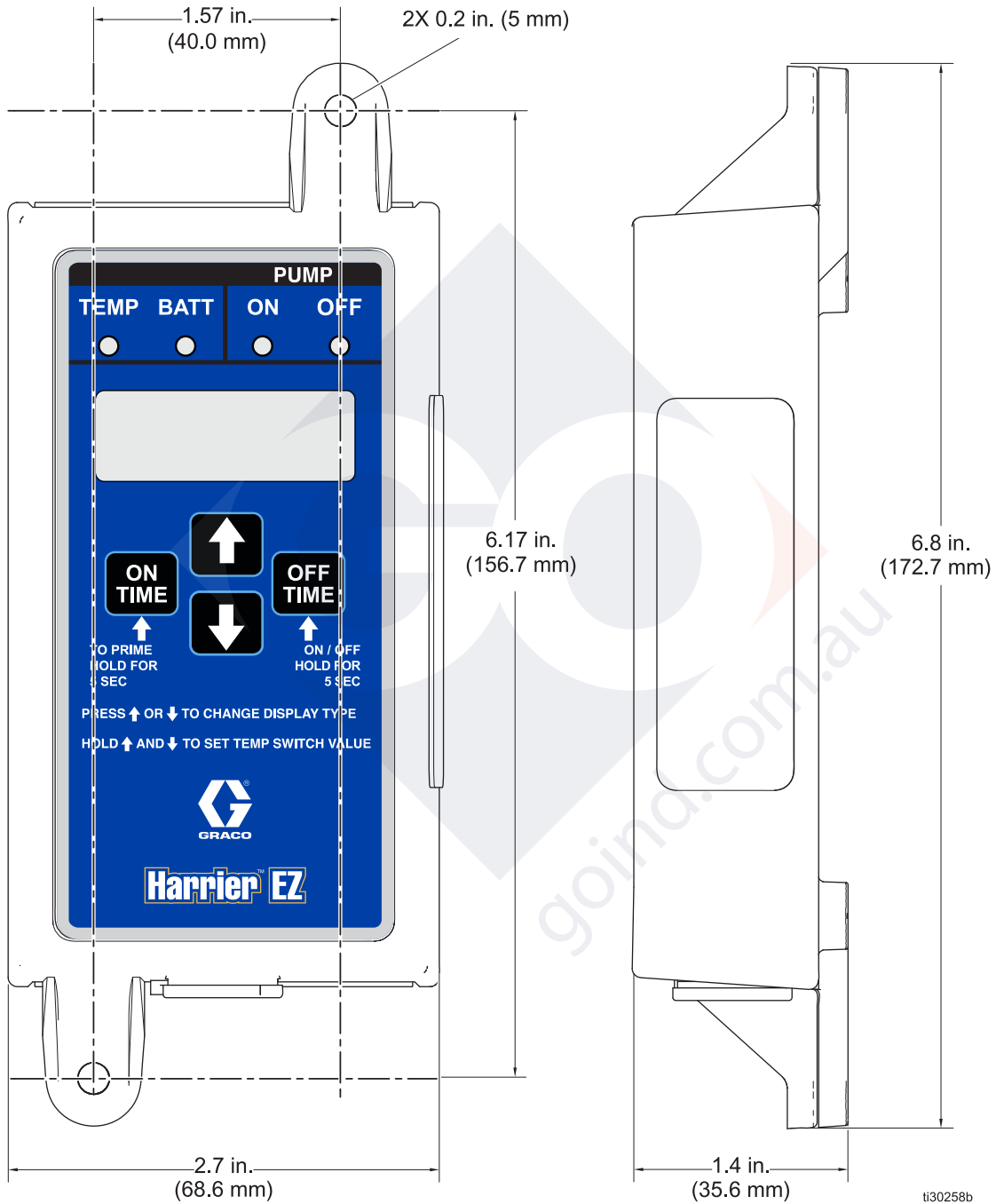

FIG. 3 Harrier EZ Controller Dimensions

Technical Data

| | |
|-----------------------------|--|
| Input Contact | |
| Power Source DC | 9 - 26 VDC |
| Power Consumption | 1 Watt |
| Outputs | |
| Pump control | Pump Control Voltage = Power Source |
| Voltage | Pump Control Voltage = Power Source |
| Max Switching Voltage | 26 VDC |
| Max Switching Current | 16A (DC) |
| Min Switching Current | 100 mA (DC) |
| Protection grade | IP54 for indoors |
| Enclosure Material | Polycarbonate + PET |
| Membrane Material | Polyester |
| Maximum Humidity | 90% Relative Humidity (non-condensing) |
| Operating temperature range | - 40°F to 131°F (- 40°C to 55°C) |
| Storage Temperature | - 40°F to 176°F (- 40°C to 80°C) |

Graco Standard Warranty

Graco warrants all equipment referenced in this document which is manufactured by Graco and bearing its name to be free from defects in material and workmanship on the date of sale to the original purchaser for use. With the exception of any special, extended, or limited warranty published by Graco, Graco will, for a period of twelve months from the date of sale, repair or replace any part of the equipment determined by Graco to be defective. This warranty applies only when the equipment is installed, operated and maintained in accordance with Graco's written recommendations.

This warranty does not cover, and Graco shall not be liable for general wear and tear, or any malfunction, damage or wear caused by faulty installation, misapplication, abrasion, corrosion, inadequate or improper maintenance, negligence, accident, tampering, or substitution of non-Graco component parts. Nor shall Graco be liable for malfunction, damage or wear caused by the incompatibility of Graco equipment with structures, accessories, equipment or materials not supplied by Graco, or the improper design, manufacture, installation, operation or maintenance of structures, accessories, equipment or materials not supplied by Graco.

This warranty is conditioned upon the prepaid return of the equipment claimed to be defective to an authorized Graco distributor for verification of the claimed defect. If the claimed defect is verified, Graco will repair or replace free of charge any defective parts. The equipment will be returned to the original purchaser transportation prepaid. If inspection of the equipment does not disclose any defect in material or workmanship, repairs will be made at a reasonable charge, which charges may include the costs of parts, labor, and transportation.

THIS WARRANTY IS EXCLUSIVE, AND IS IN LIEU OF ANY OTHER WARRANTIES, EXPRESS OR IMPLIED, INCLUDING BUT NOT LIMITED TO WARRANTY OF MERCHANTABILITY OR WARRANTY OF FITNESS FOR A PARTICULAR PURPOSE.

Graco's sole obligation and buyer's sole remedy for any breach of warranty shall be as set forth above. The buyer agrees that no other remedy (including, but not limited to, incidental or consequential damages for lost profits, lost sales, injury to person or property, or any other incidental or consequential loss) shall be available. Any action for breach of warranty must be brought within two (2) years of the date of sale.

GRACO MAKES NO WARRANTY, AND DISCLAIMS ALL IMPLIED WARRANTIES OF MERCHANTABILITY AND FITNESS FOR A PARTICULAR PURPOSE, IN CONNECTION WITH ACCESSORIES, EQUIPMENT, MATERIALS OR COMPONENTS SOLD BUT NOT MANUFACTURED BY GRACO. These items sold, but not manufactured by Graco (such as electric motors, switches, hose, etc.), are subject to the warranty, if any, of their manufacturer. Graco will provide purchaser with reasonable assistance in making any claim for breach of these warranties.

In no event will Graco be liable for indirect, incidental, special or consequential damages resulting from Graco supplying equipment hereunder, or the furnishing, performance, or use of any products or other goods sold hereto, whether due to a breach of contract, breach of warranty, the negligence of Graco, or otherwise.

FOR GRACO CANADA CUSTOMERS

The Parties acknowledge that they have required that the present document, as well as all documents, notices and legal proceedings entered into, given or instituted pursuant hereto or relating directly or indirectly hereto, be drawn up in English. Les parties reconnaissent avoir convenu que la rédaction du présente document sera en Anglais, ainsi que tous documents, avis et procédures judiciaires exécutés, donnés ou intentés, à la suite de ou en rapport, directement ou indirectement, avec les procédures concernées.

Graco Information

For the latest information about Graco products, visit www.graco.com.

For patent information, see www.graco.com/patents.

TO PLACE AN ORDER, contact your Graco distributor or call to identify the nearest distributor.

Phone: 612-623-6921 **or Toll Free:** 1-800-328-0211 **Fax:** 612-378-3505

*All written and visual data contained in this document reflects the latest product information available at the time of publication.
Graco reserves the right to make changes at any time without notice.*

Original instructions. This manual contains English. MM 3A4700

Graco Headquarters: Minneapolis

International Offices: Belgium, China, Japan, Korea

GRACO INC. AND SUBSIDIARIES • P.O. BOX 1441 • MINNEAPOLIS MN 55440-1441 • USA
Copyright 2015, Graco Inc. All Graco manufacturing locations are registered to ISO 9001.

www.graco.com

Revision E, February 2020